

GTT



Abb. 1



● Rechte Ausführung dargestellt

GTT-OH2

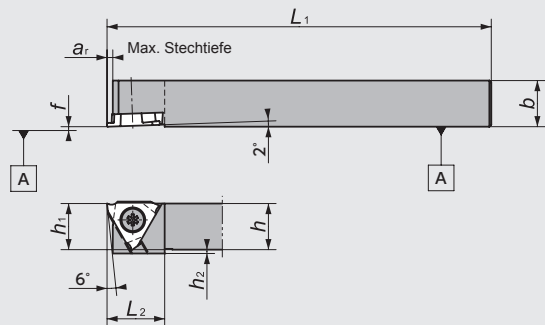
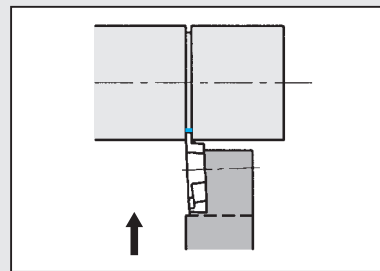

Abb. 2



● Rechte Ausführung dargestellt

GTT-OH

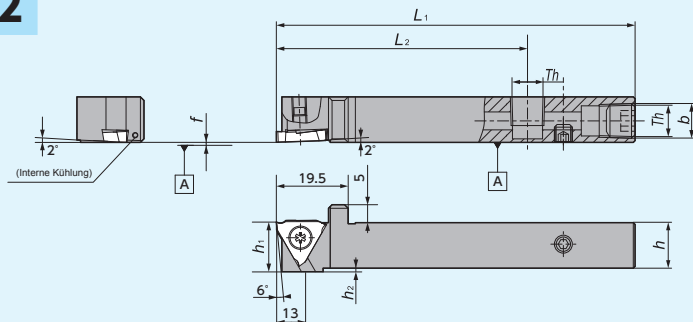
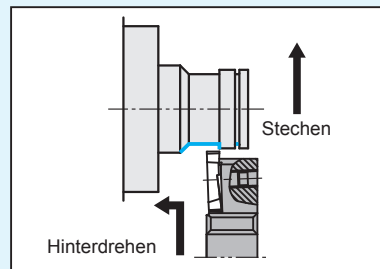
(Innenkühlung)



Abb. 3



● Rechte Ausführung dargestellt

CH-GTT

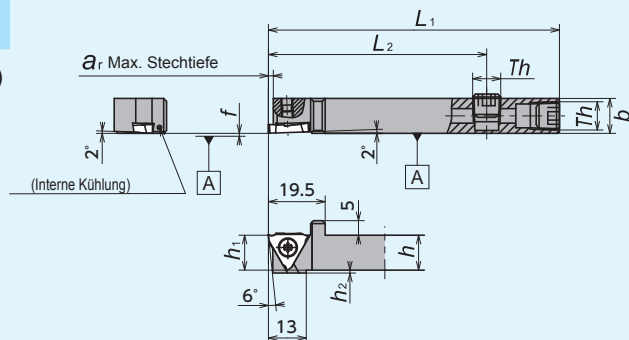
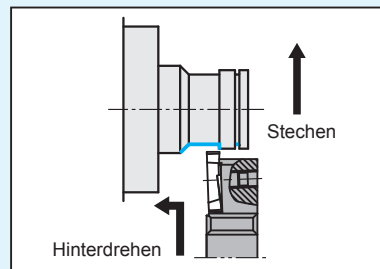

Abb. 4



☆ Rechte oder neutrale WSP verwenden
● Linke Ausführung dargestellt

DS-GTT

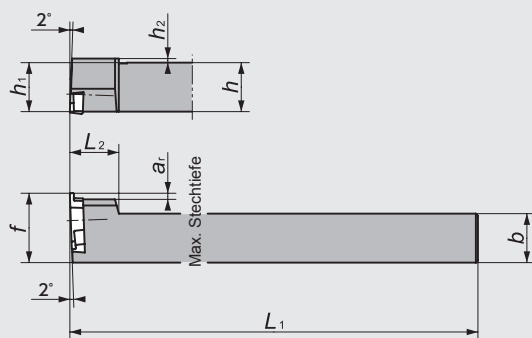
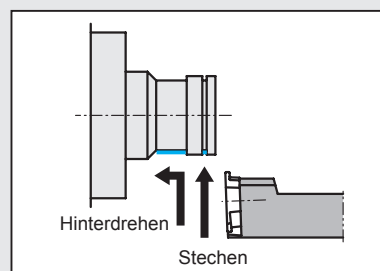
(DS-Halter)







Abb. 5

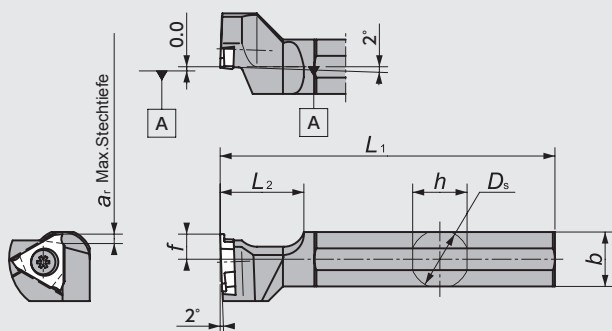
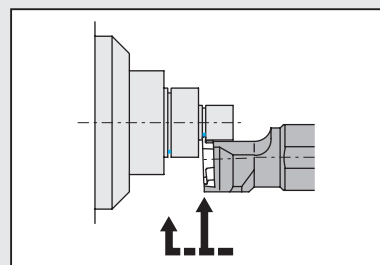

☆ Rechte oder neutrale WSP verwenden
● Linke Ausführung dargestellt

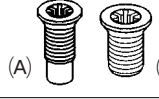
Abmessungen und Ersatzteilmformationen

Abb.	Artikelnr.		Bezeichnung	Standard		Abmessungen (mm)										Stechtiefe (mm) w	Platte 	Ersatzteile		
	R	L		R	L	h	b	L ₁	h ₁	f	L ₂	a _r	h ₂	D _s	Spannschraube			Schlüssel (A) 		
															(A) 				(B) 	
1	5107305	5107313	GTTR_L08F00	●	●		8	80										Rechts : LR-S-4 * 10PW (A) Links : LR-S-4 * 5,8 (B) LR-S-4 * 10PW (A) Rechts : LR-S-4 * 10PW (A) Links : LR-S-4 * 5,8 (B) CLR-15S (A) LR-S-4 * 10PW (A) G63		
	5608682		0810F00	●		8	10		8				5							
	5107206	5107214	08K00	●	●		8													
	5608690		0810K00	●			10													
	5107321	5107339	10F00	●	●	10	10	80												
	5107222	5107230	10K00	●	●			120				1.6		3						
	5107347	5107354	12F00	●	●			80												
	5107248	5107255	12K00	●	●	12	12	120						1						
	5459896	5551387	16H00	●	●			100												
	5173687	5173679	16K00	●	●	16	16	120						0						
	5530852	5780317	20K00	●	●	20	20	125	20					0						
	5780309	5780291	25M00	●	●	25	25	150	25	0	15									
	5107362	5107370	10F15	●	●			80												
	5107263	5107271	10K15	●	●	10	10	120						3						
	5537220	5537147	12F15	●	●			80												
	5537246	5537162	12K15	●	●	12	12	120						1						
	5537261	5537188	16H15	●	●			100												
	5537287	5537204	16K15	●	●	16	16	120						0						
	5107388	5107396	10F25	●	●			80												
	5107289	5107297	10K25	●	●	10	10	120						3						
5537238	5537154	12F25	●	●			80													
5537253	5537170	12K25	●	●	12	12	120						1							
5537279	5537196	16H25	●	●			100													
5537295	5537212	16K25	●	●	16	16	120						0							
2	5035381		GTTR_L12H00-OH2	●		12	12	100	12	0	70	1.6	1			0.30	LR-S-4 * 10PW (A)	CLR-15S		
	5043997		16X00-OH2	●		16	16	120	16				0			3.00				
3	5921705		GTTR_L1012H00-OH	●		10			10							0.30	LR-S-4 * 10PW (A)	CLR-15S (A)		
	5890157		GTTR12H00-OH	●		12		100	12	0	70	1.6	1			3.00				
	5921713		GTTR_L16H00-OH	●		16	16		16				0							
4	5659248		CH-GTTR_L10H00	●		10	10	100	10	15				3		0.30	LR-S-4 * 9 (B)	RLR-20S (B)		
	5659255		12H00	●		12	12	100	12	17	12	1.5	1			3.00				
	5960836		16H00	●		16	16	100	16	21			0							
5	5348560		DS-GTTR_L14F	●		13	13	80								14.000	LR-S-4 * 9 (B)	RLR-20S (B)		
	5348081		15H	●		15	15	100							15.875					
	5341532		16X^{※2}	●				95							16.000					
	5278288		19	●		18	18								19.050					
	5278304		20	●		19	19	120			20	1.6			20.000					
	5324041		22^{※2}	●		21	21								22.000					
	5483433		25MET	●		24	24	150			10				25.000					
	5317144		25	●		24	24	120			10				25.400					
5937693		32	●		30	30	150			10				32.000						

※1 Stechtiefe je nach Platte

※2 Bitte verwenden Sie bei den DS-Sleeve Haltern einen Halter DMR von 16mm / 22mm

Stechen & Längsrehen

Y-GTT-OH

(Y-Achse / Innenkühlung)



Abb. 1

● Rechte Ausführung dargestellt
☆ rechte Platte auf rechtem Halter verwenden

Y-GTT

(Y-Achse)

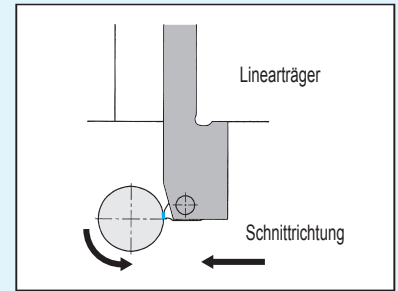
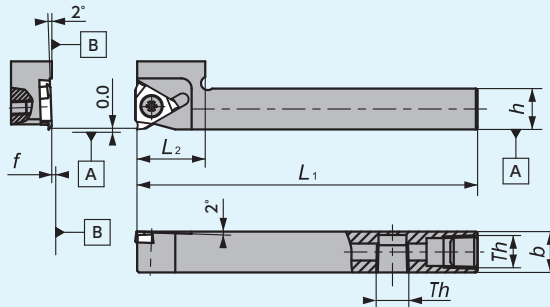

Abb. 2

● Rechte Ausführung dargestellt
☆ rechte Platte auf rechtem Halter verwenden

Abmessungen und Ersatzteilinformationen

Abb.	Artikelnr.		Bezeichnung	Standard	Abmessungen (mm)										Stechtiefe (mm) w	Platte	Ersatzteile	
	R	L			R	L	h	b	L ₁	h ₁	f	L ₂	a _r	h ₂			Spannschraube	Schlüssel
1	5911466		Y-GTT [®] /L12H00S-OH	●	12	12					20			0.30	GTMH32 GTMX32 H22~25 TBMH32	LR-S-4 * 10PW	CLR-15S	
	5911474		Y-GTT [®] /L16H00-OH	●	16	16	100		0		25			3.00 *1				
2	5371604		Y-GTT [®] /L10S	●							20			0.30 3.00 *1	LR-S-4 * 10PW	CLR-15S		
	5950415		10MS	●	10	10					22							
	5371620		12S	●			120		0		20							
	5950472		12MS	●	12	12					22							

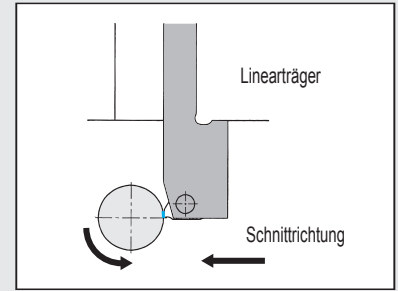
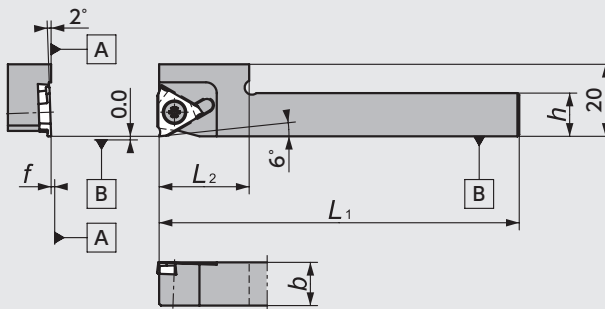
GTMX32

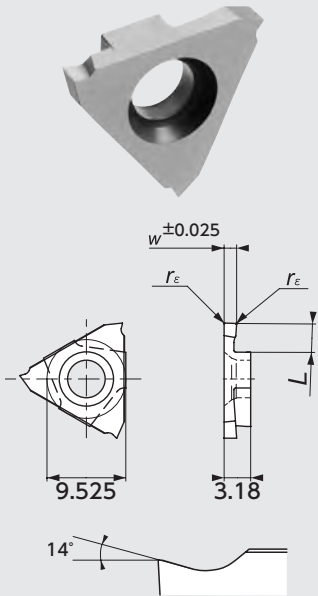
Form	Bezeichnung	Abmessungen (mm)				PVD-Beschichtetes Hartmetall							
		w	L	r _ε	Max. Stehtiefe	QM3				DT4			
						R	Standard	L	Standard	R	Standard	L	Standard
<p>Geeignet zum Längsdrehen</p>  <p>● Rechte Ausführung dargestellt</p>	GTMX32030 ^R / _L T	0.30	0.6	0.05	0.25	5510110	●			5847967	●		
	033 ^R / _L T	0.33				5510102	●						
	043 ^R / _L T	0.43	1.2	0.9	5510094	●			5847983	●			
	050 ^R / _L T	0.50			5493895	●			5847991	●			
	053 ^R / _L T	0.53			5510086	●							
	065 ^R / _L T	0.65			5510078	●			5849013	●			
	075 ^R / _L T	0.75	2.0	1.6	5493903	●	5510540	●	5848999	●	5848981	●	
	080 ^R / _L T	0.80			5510060	●			5848965	●			
	095 ^R / _L T	0.95			5493911	●	5510581	●	5848882	●	5848874	●	
	100 ^R / _L T	1.00			5493929	●			5848866	●			
	110 ^R / _L T	1.10			5510052	●							
	120 ^R / _L T	1.20			5493937	●			5848841	●			
	125 ^R / _L T	1.25			5510045	●			5848833	●			
	130 ^R / _L T	1.30			5510037	●			5848825	●			
	140 ^R / _L T	1.40			5510029	●			5848817	●			
	145 ^R / _L T	1.45			3.0	2.7	5510011	●					
	150 ^R / _L T	1.50	5493945	●			5510672	●	5848791	●	5848783	●	
	160 ^R / _L T	1.60	5510003	●					5848775	●			
	175 ^R / _L T	1.75	5510243	●					5848767	●			
	180 ^R / _L T	1.80	5510250	●					5848759	●			
	200 ^R / _L T	2.00	5510227	●			5510425	●	5848742	●	5848734	●	
	250 ^R / _L T	2.50	5510219	●			5510417	●	5848726	●	5848718	●	
	300 ^R / _L T	3.00	5510235	●					5848700	●			
	100 ^R / _L T01	1.00	2.0	1.6	5510136	●			5848692	●			
	120 ^R / _L T01	1.20			5510128	●			5848684	●			
	150 ^R / _L T01	1.50	3.0	0.1	5510482	●			5848676	●			
	200 ^R / _L T01	2.00			5510433	●	5510441	●	5848668	●	5848650	●	
	250 ^R / _L T01	2.50			5523204	●			5848627	●			
	150 ^R / _L T02	1.50	3.0	0.2	5523196	●			5848643	●			
	200 ^R / _L T02	2.00			5523188	●			5848635	●			
250 ^R / _L T02	2.50	5523170			●			5848619	●				
300 ^R / _L T02	3.00	5523162			●			5848601	●				

Stechen & Längsdrehen

NGTN

Ohne Überstand



Abb. 1



● Rechte Ausführung dargestellt

NGTB

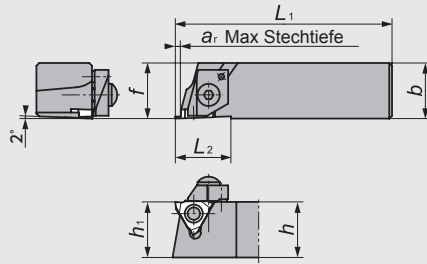
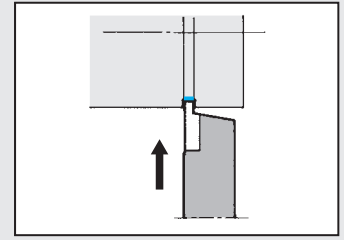
Mit Überstand



Abb. 2



● Rechte Ausführung dargestellt

NGTA

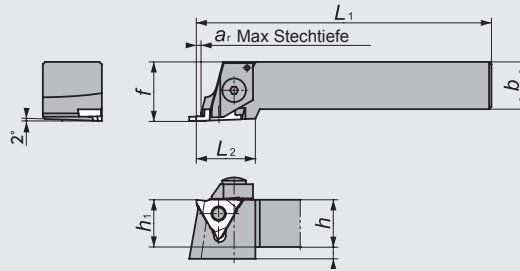
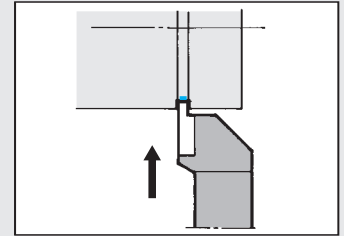

Abb. 3



● Linke Ausführung dargestellt

☆ rechte Platte auf rechtem Halter verwenden

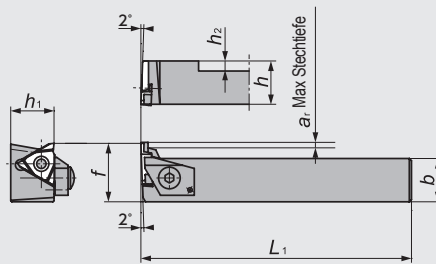
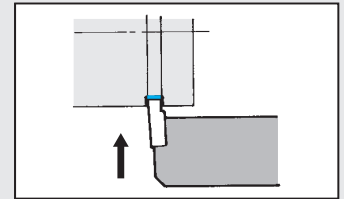
Abmessungen und Ersatzteilmformationen

Abb.	Artikelnr.		Bezeichnung	Standard	Abmessungen (mm)								Stechtiefe (mm) w	Platte	Ersatzteile				
	R	L			R	L	h	b	L ₁	h ₁	f	L ₂			a ₁	h ₂	Klemmpratte	Klemmboizen	Feder
1	5501994	5554241	NGTN ^{R/L} 161643-20	● ●										2.00-3.49	GTMA43 GTMT43 H27	CPR/L5S	AOS-5*20	ASG-5	LW-2.5
	5534136	5222112	161643-35	● ●	16	16	78	16	16	20	4.5	9	3.50-5.50						
2	5239900	5239843	NGTB ^{R/L} 161643-00S	● ●									3.0	1.00-2.49	GTMA43 GTMT43 H27	CPR/L5	AOS-5*25	ASG-5	LW-2.5
	5949615	5210901	161643-20S	● ●	16	16	100	16	20			4.5	2.00-3.49						
	5806096	5222021	161643-35S	● ●									3.50-5.50						
	5239850	5239868	202043-00S	● ●								3.0	1.00-2.49						
	5550041	5553367	202043-20S	● ●	20	20	125	20	25			5	2.00-3.49						
	5553375	5222039	202043-35S	● ●						25		4.5	3.50-5.50						
	5239876	5239892	252543-00S	● ●								3.5	1.00-2.49						
	5550058	5550066	252543-20S	● ●	25		150	25					2.00-3.49						
	5550074	5550082	252543-35S	● ●		25			30				3.50-5.50						
	5553433	5553441	322543-20S	● ●								5.5	2.00-3.49						
5222013	5222047	322543-35S	● ●	32		170	32					3.50-5.50							
3	5004155	NGTA ^{R/L} 161643-00S	● ●	16	16	100	16	23	—	3.0	4	1.00-2.49	GTMA43 GTMT43 H27	CPR/L5S*	AOS-5*20	ASG-5	LW-2.5		
	5884903	202043-00S	● ●	20	20	125	20	27	—	3.0	—	※1						CPR/L6*	AOS-6*30

※1 Stechtiefe je nach Platte

GTMT43/GTMA43

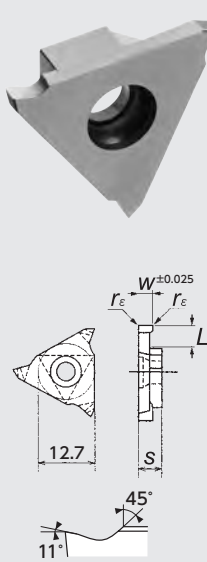
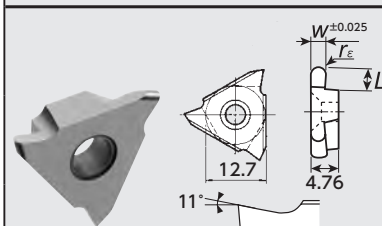
Form	Bezeichnung	Abmessungen (mm)					PVD-Beschichtetes Hartmetall							
		w	L	r _ε	s	Max. Stechtiefe	QM3				DM4			
							R	Standard	L	Standard	R	Standard	L	Standard
 <p>● Rechte Ausführung dargestellt</p>	GTMT43145 R _L	1.45	3.5	0.2	3.0	5238076	●	5237912	●	5846852	●	5846860	●	
	150 R _L	1.50				5238084	●	5237920	●	5846837	●	5846845	●	
	175 R _L	1.75				5238092	●	5237938	●	5846811	●	5846829	●	
	185 R _L	1.85				5238100	●	5237946	●	5846795	●	5846803	●	
	200 R _L	2.00				5238118	●	5237953	●	5846779	●	5846787	●	
	230 R _L	2.30				5238126	●	5237961	●	5846753	●	5846761	●	
	 <p>● Rechte Ausführung dargestellt</p>	250 R _L	2.50	5.5	0.3	4.76	5238134	●		5846746	●			
		265 R _L	2.65				5238142	●		5846910	●			
		280 R _L	2.80				5238159	●	5237904	●	5846902	●	5846738	●
		300 R _L	3.00				5238167	●	5237987	●	5846894	●	5846720	●
		330 R _L	3.30				5238175	●	5237995	●				
		350 R _L	3.50				5238183	●	5238001	●	5846704	●	5846712	●
		400 R _L	4.00				5238191	●	5238019	●	5846688	●	5846696	●
		430 R _L	4.30											
		450 R _L	4.50				5238233	●	5238035	●	5846639	●	5846670	●
500 R _L		5.00	5238241				●	5238043	●	5846613	●	5846621	●	
550 R _L	5.50	5238258	●	5238050	●	5846597	●	5846605	●					
 <p>● Rechte Ausführung dargestellt</p>	GTMA43200 R _L 10R	2.00	3.5	1.0	—	3.0	5437918	●						
	300 R _L 15R	3.00	5.5	1.5		4.5	5437926	●						
	400 R _L 20R	4.00	2.0	5437934		●								

GTV



Abb. 1

● Rechte Ausführung dargestellt

GKV

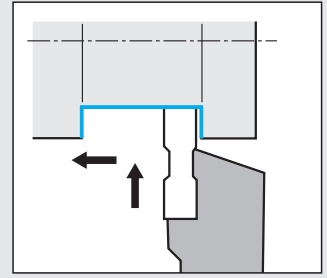
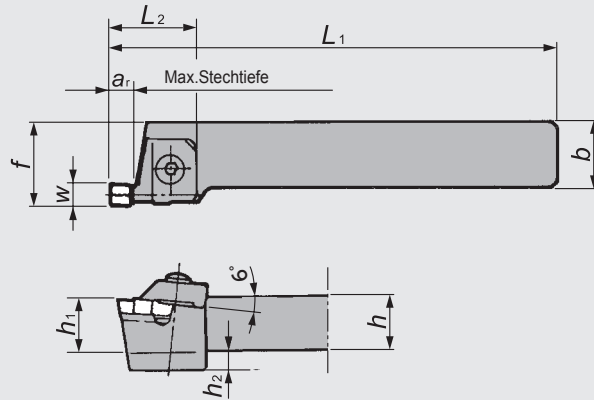

Abb. 2

● Rechte Ausführung dargestellt

Abmessungen und Ersatzteilinformationen

Abb.	Artikelnr.		Bezeichnung	Standard	Abmessungen (mm)								Stechtiefe (mm)	Platte	Ersatzteile				
	R	L			R	L	h	b	L ₁	h ₁	f	L ₂			a _r	h ₂	w	Klemmplatte	Klemmbolzen
1	5765920		GTV[®]L16-3N	●		16	16	100	16	20	25		9	3.00 3.50	GEV300N(04) GEV350N(04) H31	CVR/L3SN	AOB-5C	ASG-5	LW-3
	5778980		20-3N	●		20	20	125	20	25	32		0						
	5801667	5801675	25-3N	●	●	25	25	150	25	30	32								
	5657739	5657747	16-4N	●	●	16	16	100	16	20	25		9	4.00 5.90		CVR/L4SN	AOB-5C	ASG-5	LW-3
	5657754	5657762	20-4N	●	●	20	20	125	20	25	32	11							
	5657770	5657788	25-4N	●	●	25	25	150	25	30	32								
	5657796	5657804	20-6	●	●	20	20	125	20	25	32		0	6.00 7.90		CVR/L6	AOB-6C	ASG-6	LW-4
	5609193	5611397	25-6	●	●	25	25	150	25	30	32								
	5657812		20-8	●		20	20	125	20	25	32			8.00 9.00	GEV H31	CVR/L8			
	5657697	5657705	25-8	●	●	25	25	150	25	30	32								
2	5657820	5657838	GKV[®]L20-4N	●	●	20	20	125	20	33	32			4.00 5.90	GTV GVGN H31	CVR/L4N *			
	5657846	5657853	25-4N	●	●	25	25	150	25	38	32								
	5657861		20-6	●		20	20	125	20	33	32			6.00 7.90		CVR/L6 *	AOB-6C	ASG-6	LW-4
	5657713	5657721	25-6	●	●	25	25	150	25	38	32								
			20-8			20	20	125	20	33	32			8.00 9.00		CVR/L8 *			
		25-8			25	25	150	25	38	32									

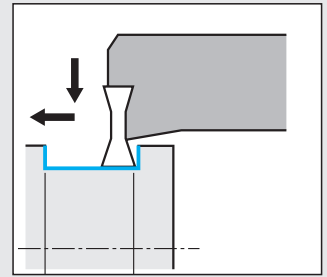
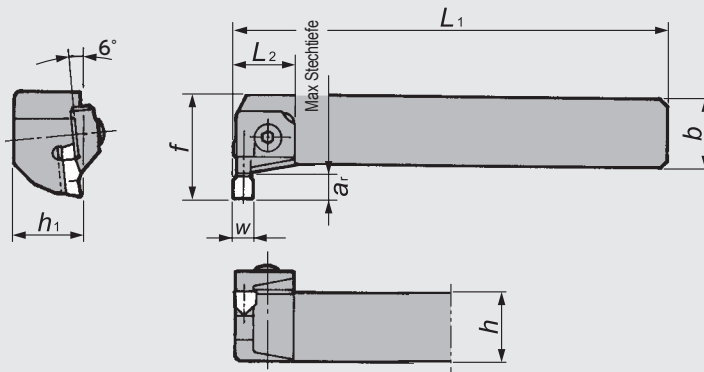
※links ausgerichtete Klemmplatte auf rechtem Halter und rechts ausgerichtete Klemmplatte auf linkem Halter verwenden!

GTV

Form	Bezeichnung	Abmessungen (mm)			PVD-Beschichtetes Hartmetall	
		w	S	r _ε	QM3	Standard
	GTV400N	4.0	8.5	0.15	5027610	●
	400N04			0.4	5046727	●
	GTV600N	6.0	8.5	0.15	5027602	●
	600N04			0.4	5046735	●

GEV

Form	Bezeichnung	Abmessungen (mm)			PVD-Beschichtetes Hartmetall	
		w	S	r _ε	QM3	Standard
	GEV300N	3.0	5.2	0.2	5027586	●
	300N04			0.4	5048392	●
	GEV350N04	3.5	0.4	5053616	●	
	GEV400N	4.0	0.2	5046818	●	
	400N04		0.4	5035233	●	
	GEV450N04	4.5	0.4	5227517	●	
	GEV500N	5.0	0.2	5046800	●	
	500N04		0.4	5035225	●	
	GEV550N04	5.5	0.4	5255385	●	
	GEV600N	6.0	0.2	5082961	●	
	600N04		0.4	5042189	●	
	GEV650N04	6.5	0.4	5064191	●	
	GEV700N04	7.0	0.4	5037080	●	
GEV750N04	7.5	0.4	5255393	●		
GEV800N04	8.0	0.4	5255401	●		

GVGN

Form	Bezeichnung	Abmessungen (mm)			Keramik	
		w	S	r _ε	HC2	Standard
<p>Ohne Spanbrecher</p>	GVGN20400N	4.0	8.5	0.2		
	20500N	5.0				
	20600N	6.0				
	20700N	7.0				
	20800N	8.0				
	20900N	9.0				

※Nur auf Bestellung

S-BG (Mogul Bar)



Abb. 1

● Rechte Ausführung dargestellt
Linke Platte verwenden

BG

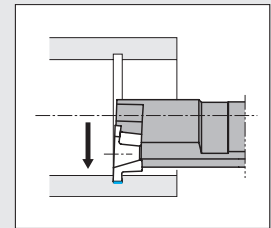
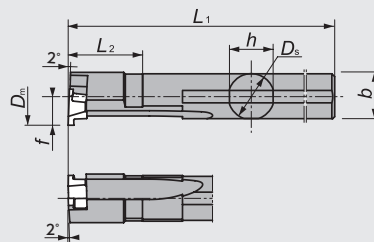

Abb. 2

● Rechte Ausführung dargestellt
Linke Platte verwenden

Abmessungen und Ersatzteilinformationen

Abb.	Artikelnr.		Bezeichnung	Standard		Min. Durchmesser (mm) D_m	Stechtiefe (mm) a_r	Abmessungen (mm)						Stechbreite (mm) w	Platte	Ersatzteile	
	R	L		R	L			D_s	h	b	L_1	f	L_2			Spannschraube	Schlüssel
1	5854500		S08H-BG$\frac{R}{L}$10D10	●		10.0	1.0	8	7.7	7.85	120	5.0	20	0.50 ~ 2.00	GTG10	LR-S-2.5*6.8	CLR-15S (A)
	5854518		S10K-BG$\frac{R}{L}$10D12	●		12.0	1.0	10	9.6	9.8	120	6.0	25				
2	5711585		BG$\frac{R}{L}$08-00S	●		10.0	1.0	8	7.0	7.5	125	5.0	20	0.50 ~ 2.00	GTG10	LR-S-2.5*6.8	CLR-15S (A)
	5711593		08-10S	●		10.0	1.0	8	7.0	7.5	125	5.0	20	1.50 ~ 2.00			
	5711601		10-00S	●		12.0	1.0	10	9.0	9.5	150	6.0	25	0.50 ~ 2.00	GTG10	LR-S-2.5*6.8	CLR-15S (A)
	5711619		10-10S	●		12.0	1.0	10	9.0	9.5	150	6.0	25	1.50 ~ 2.00			
	5711627		12-00S	●		14.0	2.0	12	11.0	11.5	180	7.0	30	1.00 ~ 2.00	GTG14	LR-S-3*7.8	RLR-20S (B)
	5711635		12-12S	●		14.0	2.0	12	11.0	11.5	180	7.0	30	1.75 ~ 2.00			
	5711643		14-00S	●		16.0	2.0	14	13.0	13.5	180	8.0	35	1.00 ~ 2.00	GTG14	LR-S-3*7.8	RLR-20S (B)
	5711650		14-12S	●		16.0	2.0	14	13.0	13.5	180	8.0	35	1.75 ~ 2.00			
	5536362		16	●		20.0	3.0	16	15.0	15.5	200	10.0	40	1.50 ~ 2.00	GTG20	LR-S-3*7.8	RLR-20S (B)
	5435433		20	●		25.0	3.0	20	19.0	19.5	200	12.0	40				

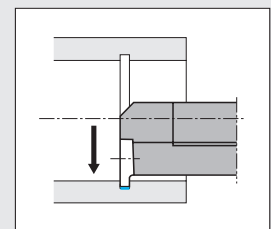
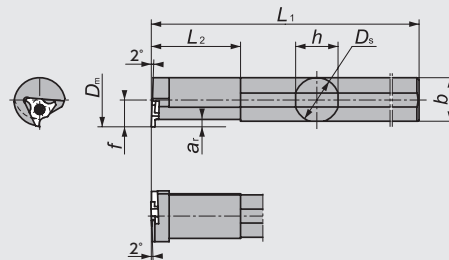
Wendeschneidplatten

Form	Bezeichnung	Abmessungen (mm)					PVD-Beschichtetes Hartmetall					
		w	Max. Stechtiefe	L	r_e	d_1	TM4	Standard	ZM3	Standard	QM3	Standard
<p>● Left-Hand style shown</p>	GTG10050FL005	0.50	1.0	1.2	0.05	5.56	5853130	●				
	10075FL005	0.75					5853114	●				
	10100FL005	1.00					5853098	●				
	10150FL005	1.50					5853080	●				
	10200FL005	2.00					5853072	●				
	GTG10050FL00	0.50									5514088	●
	10065FL00	0.65					5514104	●				
	10075FL00	0.75					5376835	●				
	10100FL00	1.00					5376843	●				
	10150FL00	1.50					5376850	●				
10200FL01	2.00					5357884	●					
GTG14100FL00	1.00					5376868	●					
14150FL00	1.50	2.0	2.2	0.05	7.94	5376876	●					
14200FL01	2.00					5376884	●					
GTG20150FL	1.50								5396239	●		
20200FL	2.00	3.0	3.2	0.2	9.525				5376991	●		

GKV

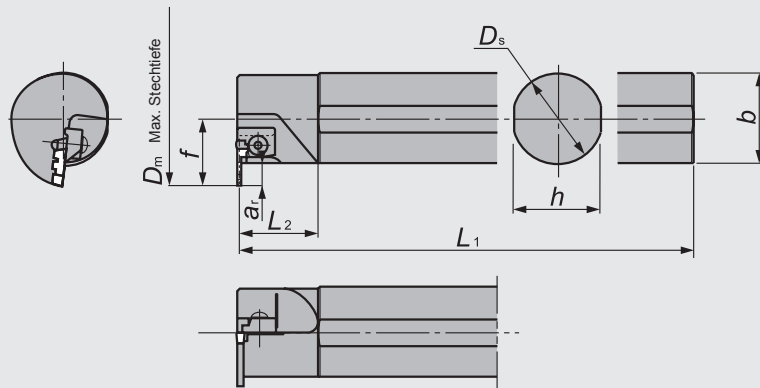

Abmessungen und Ersatzteilm Informationen

Artikelnr.		Bezeichnung	Standard		Min. Durchmesser D_m (mm)	Abmessungen (mm)							Stechbreite (mm) w	Platte	Ersatzteile			
R	L		R	L		D_s	h	b	L_1	f	L_2	a_r			Klemmplatte	Klemmbolzen	Feder	Schlüssel
5255567		GKV^R 3230-3	●		30	32	30	31	200	21	50	5.5	3.00 }	GEV	CVL/R3SN ※	AOB-5C	ASG-5	LW-3
5255559		3240-3	●		40	32	30	31	250	23	50	7.5						
5255542		4055-3	●		55	40	38	39	300	29	35	9.5						

Wendeschneidplatten

Form	Bezeichnung	Abmessungen (mm)			PVD-Beschichtetes Hartmetall	
		w	S	r_ϵ	QM3	Standard
	GEV300N	3.0	5.2	0.2	5027586	●
	300N04			0.4	5048392	●
	GEV350N04	3.5		0.4	5053616	●