

SS Tools for Cutting off

CTP Series Max. Cut-off Dia. ~ 12.0mm

Unique Swiss Tooling

CTP

Screw accessible from both sides

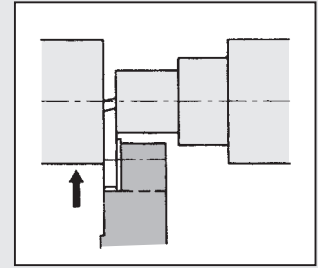
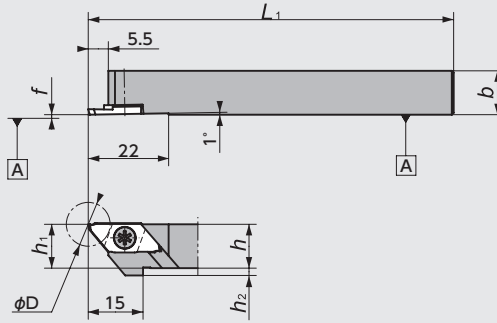

● Right-Hand style shown

Figure-1

CTP-OH2

(Coolant through)
Screw accessible from both sides

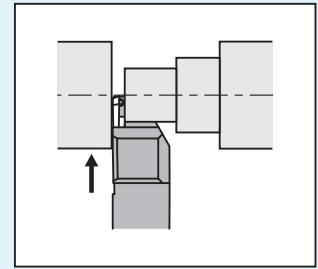
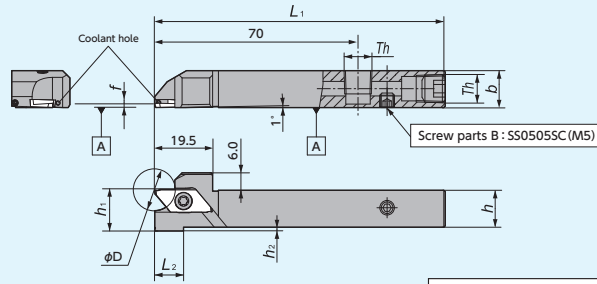

● Right-Hand style shown

Figure-2 ● Left-Hand holders are designed for Right-Hand machines

Th (Screw parts A)
1212 size: SPR1/8(Rc1/8)

Front Turning

CTP-OH

(Coolant through)
Screw accessible from both sides

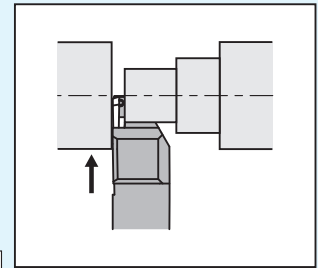
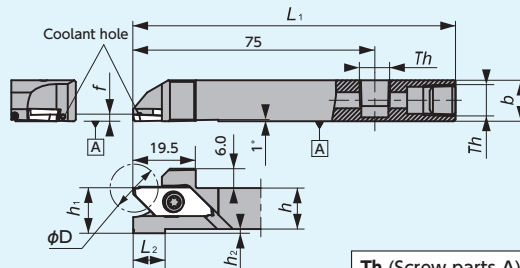

● Right-Hand style shown

Figure-3 ● Left-Hand holders are designed for Right-Hand machines

Th (Screw parts A)
1012 size: SS06055C (M6×1.0)
1212/1616 size: SPR1/8(Rc1/8)

Back Turning

CTPR-SUB

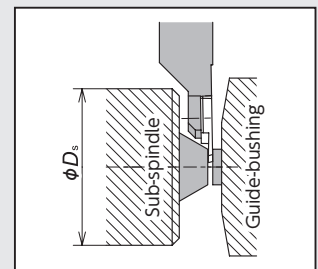
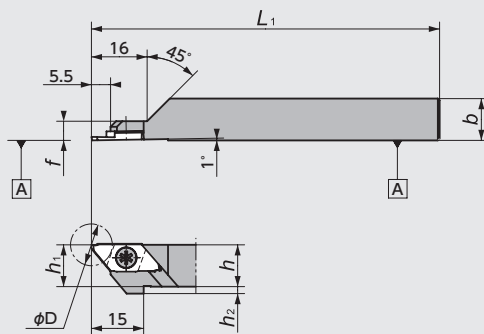

● Right-Hand style shown

Figure-4

φDs
CTPR-SUB: φ30mm

Cut-off

CTPL-SUB

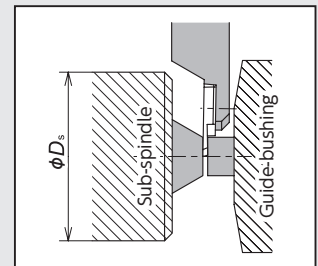
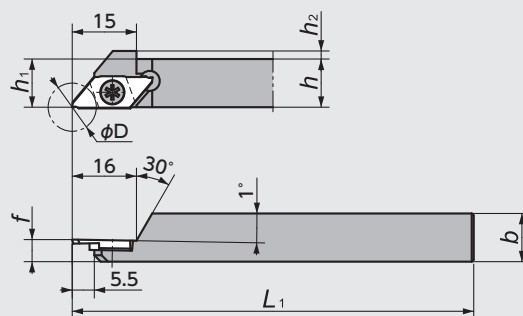







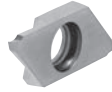

● Left-Hand style shown

Figure-5

φDs
CTPL-SUB: φ30mm

Original Series

CTP Series - Toolholders

Figure	Code No.		Item Number	Stock		Max. Cut-off Dia (mm) ϕD	Dimensions (mm)						Gage insert 	Spare Parts				
	R	L		R	L		h	b	L_1	h_1	h_2	L_2		f	Clamp Screw (A)  (B) 		Wrench (A)  (B) 	
1	5131362	5131354	CTP ^{R/L} 08	●	●	12.0※	8		120	8	4	0	0.0	CTP-CX CTP CTP-X CTPX G76~79	 (A)  (B)	 (A)  (B)		
	5873849	5893458	10H	●	●		10	10	100									
	5089644	5089636	10	●	●				120	10	2	0						
	5459730	5459748	12GX	●	●		12	12	85	12								
	5089651	5089669	12	●	●				120									
	5089677	5089685	13	●	●		13	13		13	0	0						
	5459755		16H	●			16	16	100	16								
	5183496	5183504	16	●	●				120									
2	5037874	5037866	CTP ^{R/L} 12H-OH2	●	●	12.0※	12	12	100	12	2	10	1.5※	CTP-CX CTP CTP-X CTPX G76~79	LRIS-4*12PW (A)	CLR-15S (A)		
3	5921853	5921861	CTP ^{R/L} 1012H-OH	●	●	12.0※	10	12			4	19	1.5※	CTP-CX CTP CTP-X CTPX G76~79	LRIS-4*12PW (A)	CLR-15S (A)		
	5918651	5918040	12H-OH	●	●		12	12	100		2	10						
	5921879	5921887	16H-OH	●	●		16	16		16	0	0						
4	5571831		CTPR 08-SUB	●		12.0※	8	8	120	8	4	0	5.5	CTP-CX CTP-FR (N) (V) (NV) CTP-FRX (FRNX) CTPX-FR (N) G76~79	LRIS-4*5 (B)	LLR-25S (B)		
	5607999		08J-SUB	●			110											
	5391610		10F-SUB	●			10	10	80	10	2	0						
	5605282		10KX-SUB	●			120											
	5474580		12GX-SUB	●			12	12	85	12	0	0						
	5391628		12-SUB	●			120											
5		5570791	CTPL 08-SUB	●		12.0※	8	8	120	8	4	0	5.5	CTP-CX CTP-FLK CTP-FLKV CTP-FLN CTP-FLNV CTPX-FLN CTPX-FLNX G76~79	LRIS-4*5 (B)	LLR-25S (B)		
		5608005	08J-SUB	●			110											
		5499389	10GX-SUB	●			10	10	85	10	2	0						
		5482534	12GX-SUB	●			12	12		12	0	0						

※ Would be changed by insert.

CTP Series - Inserts (Without Chipbreaker) Mirror finish

Shape	Item Number	*1 Max. Cut-off Dia (mm) ϕD	Dimensions (mm)				Carbide		PVD Coated Carbide					
			w	A	**2 θ	r_ϵ	KM1	Stock	ZM3	Stock	VM1	Stock	DT4	Stock
<p>• Right-Hand style shown</p>	CTP10FRV	12.0	1.0	0.40	20°	0.0	5576079	●	5255708	●	5264841	●	5847942	●
	15FRV		1.5	0.58			5576087	●	5255682	●	5264858	●		
	20FRV		2.0	0.77			5576095	●	5255666	●	5264866	●		
	CTP15FRNV		1.5	—	0°		5576111	●						
	20FRNV		2.0	—			5576020	●						
	CTP10FLV		12.0	1.0	0.40		20°	0.0			5255641	●	5264882	●
	15FLV	1.5		0.58					5255625	●	5264890	●		
	20FLV	2.0		0.77					5255609	●	5264908	●		
	CTP15FLNV	1.5		—	0°	5576012	●							
	20FLNV	2.0		—		5576004	●							
	CTP15FLKV	11.0		1.5	0.58	20°	0.0		5576103	●		5264874	●	
	20FLKV		2.0	0.77							5392691	●		

※ 1: Max. cut-off diameter shows when X end point is 0.0. For more information, see page G67.
 ※ 2: All angles shown are obtained when insert is set in the holder.

CTP Series - Inserts (Ground Chipbreaker : cost advantage style)

Shape	Item Number	*1 Max. Cut-off Dia (mm) ϕD	Dimensions (mm)				PVD Coated Carbide					
			w	A	**2 θ	r_ϵ	ZM3	Stock	QM3	Stock	DT4	Stock
<p>• Right-Hand style shown</p>	CTPX15FR	12.0	1.5	0.46	16°	0.05	5334909	●	5535729	●	5827514	●
	20FR		2.0	0.61			5334834	●	5535745	●	5850169	●
	CTPX15FRN		1.5	—	0°				5535711	●	5850193	●
	20FRN		2.0	—					5535737	●	5850144	●
	CTPX15FL		1.5	0.46	16°						5850227	●
	20FL		2.0	0.61							5850185	●
	CTPX15FLN	1.5	—	0°					5535653	●	5850201	●
	20FLN	2.0	—						5535638	●	5830468	●
	CTPX15FLK	11.0	1.5	0.46	16°	0.05			5535646	●	5850219	●
	20FLK		2.0	0.61					5535620	●	5850177	●

※ 1: Max. cut-off diameter shows when X end point is 0.0. For more information, see page G67.
 ※ 2: All angles shown are obtained when insert is set in the holder.

CTPA Series Max. Cut-off Dia. ~ 16.0mm

CTPA

Screw accessible from both sides

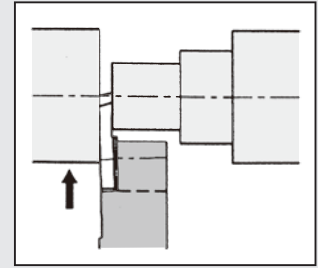
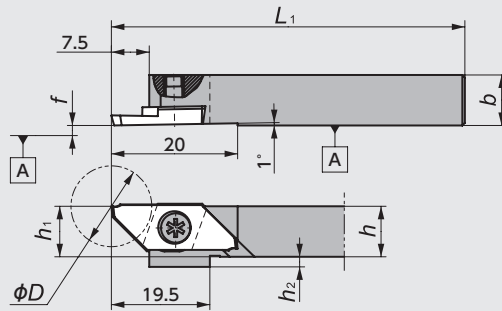

● Right-Hand style shown

Figure-1

CTPA-OH2

□12 : CTPA $\frac{R}{L}$ 12H-OH2

□16 : CTPA $\frac{R}{L}$ 16X-OH2

(Coolant through)

Screw accessible from both sides

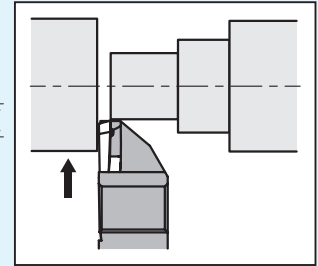
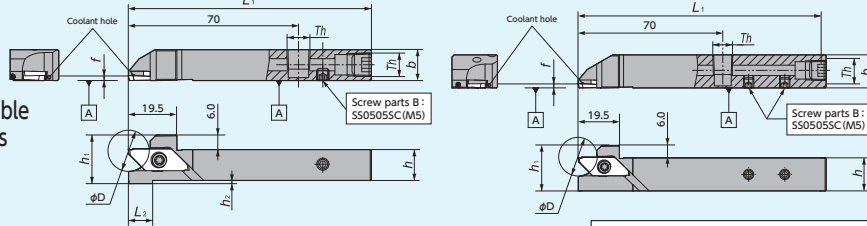

● Right-Hand style shown

Figure-2 ● Left-Hand holders are designed for Right-Hand machines

Th (Screw parts A)
1212/1616 size : SPR1/8(Rc1/8)

CTPA-OH

(Coolant through)

Screw accessible from both sides

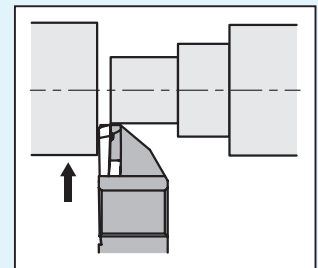
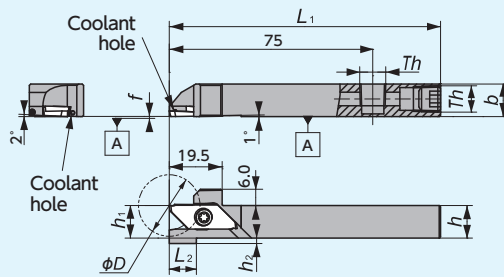

● Right-Hand style shown

Figure-3 ● Left-Hand holders are designed for Right-Hand machines

Th
□12, □16 : Rc1/8 (PT1/8)

CTPAR-SUB

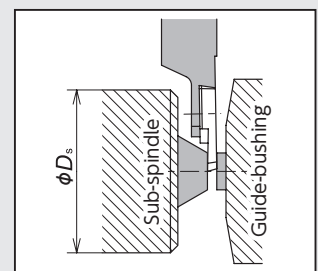
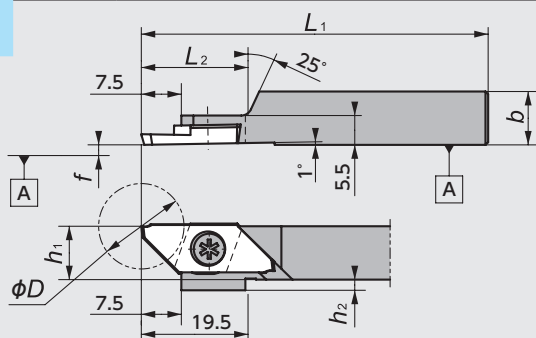

● Right-Hand style shown

Figure-4

ϕDs
CTPAR-SUB : ϕ36mm

CTPAL-SUB

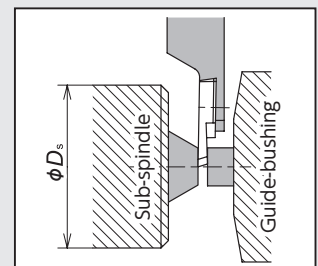
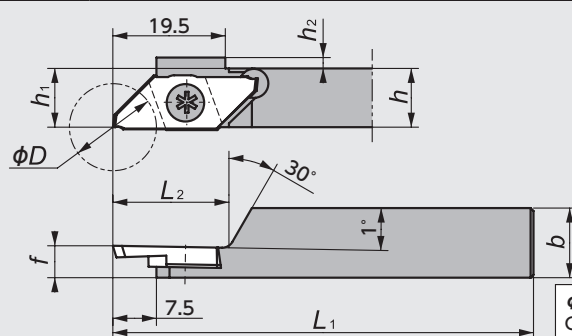



● Left-Hand style shown

Figure-5

ϕDs
CTPAL-SUB : ϕ36mm

CTPA Series - Toolholders

Figure	Code No.		Item Number	Stock		Max. Cut-off Dia (mm) ϕD	Dimensions (mm)							Gage insert 	Spare Parts		
	R	L		R	L		h	b	L ₁	h ₁	h ₂	L ₂	f		Clamp Screw		Wrench
															(A)	(B)	(A)
1	5199187	5199153	CTPA $\frac{R}{L}$ 10	●	●	16.0 ※	10	10	120	10	2	—	0.0	CTPA (Cut-off) G82~84 TBPA (Back Turning) G55	LRIS-4*10PW (A)		 (A) (B)
	5016209	5016217	12GX	●	●		12	12	85	12	0				LRIS-4*12PW (A)	CLR-15S (A)	
	5199195	5199161	12	●	●		16	16	16	16	0				LRIS-4*10 (B)	LLR-25S (B)	
	5199203	5199179	16	●	●		20	20	80	20	0						
	5459540	5459557	20F	●	●												
2	5037932	5037924	CTPA $\frac{R}{L}$ 12H-OH2	●	●	16.0 ※	12	12	100	12	2	10	2.0※	CTPA (Cut-off) G82~84	LRIS-4*12PW (A)		CLR-15S (A)
	5043872	5043864	16X-OH2	●	●		16	16	120	16	0	0	2.0※				
3	5931522	5931530	CTPA $\frac{R}{L}$ 12H-OH	●	●	16.0 ※	12	12	100	12	2	10	2.0※	CTPA (Cut-off) G82~84	LRIS-4*12PW (A)		CLR-15S (A)
	5931548	5931563	16H-OH	●	●		16	16		16	0	0	2.0※				
4	5600770		CTPAR10GX-SUB	●		16.0 ※	10	10	85	10	2	20	0.0	CTPA-FR (N)(V)(NV) G82~84	LRIS-4*5 (B)		LLR-25S (B)
	5454681		12GX-SUB	●			12	12		12	0						
	5570676		12KX-SUB	●			120										
5		5505904	CTPAL10GX-SUB		●	16.0 ※	10	10	85	10	2	5.5	CTPA-FL (N)(K)(NV)(KV) G82~84	LRIS-4*5 (B)		LLR-25S (B)	
		5454699	12GX-SUB		●									20			
		5570684	12KX-SUB		●		12	12		12					0		
		5604871	16GX-SUB		●		16	16		85	16				28		
		5981659	16KX-SUB		●		120										

※ Would be changed by insert.

CTPA Series - Inserts (Ground Chipbreaker)

Shape	Item Number	※1 Max. Cut-off Dia (mm) ϕD	Dimensions (mm)				PVD Coated Carbide					PCD			
			w	A	※2 θ	r_ϵ	ZM3 Stock	QM3 Stock	VM1 Stock	DT4 Stock	PD1 Stock				
	CTPA07FR	8.0	0.7	0.23	16°	0.05	5501242	●							
	10FR	12.0	1.0	0.32			5501218	●							
	15FR	16.0	1.5	0.46			5248075	●	5270020	●	5439328	●	5855077	●	
	20FR	16.0	2.0	0.61			5194113	●	5229596	●	5439310	●	5854997	●	
	CTPA07FRN	8.0	0.7	—	0°	0.05	5512496	●							
	10FRN	12.0	1.0	—			5496880	●							
	15FRN	16.0	1.5	—			5271473	●	5556881	●	5415096	●	5855051	●	
	20FRN	16.0	—	—			5199146	●	5562715	●	5476338	●	5854989	●	
	20FRN-P	16.0	2.0	—										5781620 (1 corner)	●
	30FRN	3.0	—	—						5789151	●				
	CTPA07FL	8.0	0.7	0.23	16°	0.05	5501234	●							
	10FL	12.0	1.0	0.32			5501226	●							
	15FL	16.0	1.5	0.46			5342688	●				5855101	●		
	20FL	16.0	2.0	0.61			5199138	●				5855036	●		
	CTPA10FLN	12.0	—	—	0°	0.05	5496898	●							
	10FLND	12.0	1.0	—			5789599	●							
	15FLN	16.0	1.5	—			5286349	●	5562707	●	5365747	●	5855085	●	
	20FLN	16.0	2.0	—			5199120	●	5250964	●	5439351	●	5854971	●	
	20FLN-P	16.0	—	—										5781646 (1 corner)	●
	30FLN	3.0	—	—						5782677	●				
	CTPA07FLK	6.5	0.7	0.23	16°	0.05	5505912	●							
	10FLK	11.0	—	0.32			5496906	●							
	10FLKD	16.0	1.0	0.32			5789607	●							
	15FLK	14.5	1.5	0.46			5248083	●	5562699	●	5476320	●	5855093	●	
	20FLK	14.5	2.0	0.61			5199112	●	5250774	●	5439369	●	5855002	●	

※1: Max. cut-off diameter shows when X end point is 0.0. For more information, see page G67.
 ※2: All angles shown are obtained when insert is set in the holder.

SS Tools for Cutting off

CTDP (Cut Duo) Series Max. Cut-off Dia. ~ 20.0, ~ 25.4, ~ 32.0, ~ 34.0mm

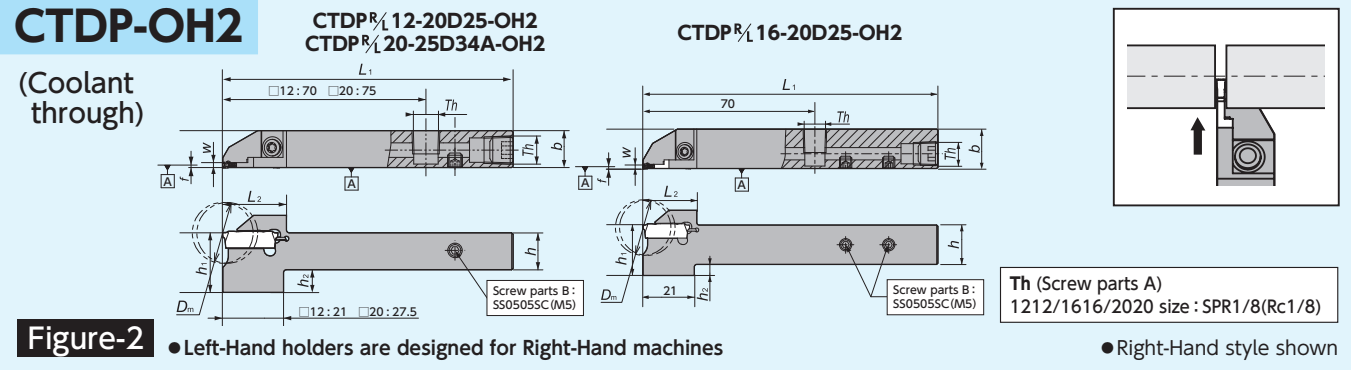
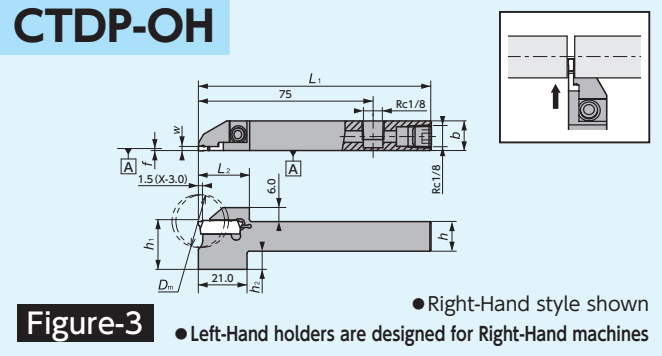
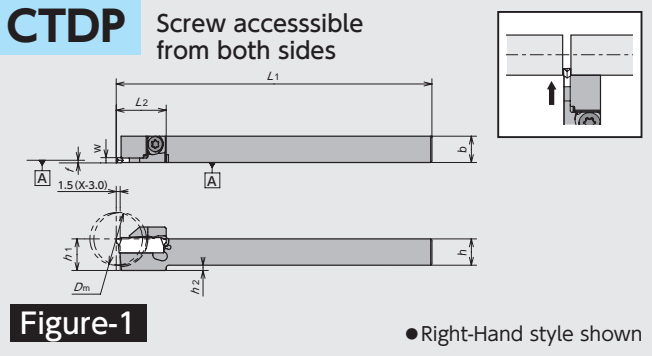

CTDP Series - Toolholders

Figure	Code No.		Item Number	Stock		Max. Cut-off Dia (mm) D _m	Dimensions (mm)							Gage insert	Spare Parts	
	R	L		R	L		w	h	b	L ₁	h ₁	h ₂	f		L ₂	Clamp Screw
1	5750534	5750559	CTDP _{R/L} 10-20D20	●	●	20.0	2.0	10	10	120	10	2	0.15	CTDP20	LRIS-4 * 12	LLR-25S
	5717087	5717079	12-20D20	●	●		2.0	12	12	120	12	0				
	5717103	5717095	12-20D25	●	●	25.4	2.0	12	12	120	12	0				
	5750567	5750575	16-20D25	●	●		2.0	16	16	120	16	0				
	5842299	5842307	16-20D32A	●	●	32.0	2.0	16	16	120	16	0				
	5842331	5842349	2012-20D32A	●	●		2.0	20	12	120	20	0				
	5842315	5842323	20-20D32A	●	●	34.0	2.0	20	20	120	20	0				
	5842356	5842364	16-25D34A	●	●		2.5	16	16	120	16	0				
	5842398	5842406	2012-25D34A	●	●	34.0	2.5	20	12	120	20	0				
	5842372	5842380	20-25D34A	●	●		2.5	20	20	120	20	0				
2	5037916	5037908	CTDP _{R/L} 12-20D25-OH2	●	●	25.4	2.0	12	12	100	20.5	8.5	0.15	CTDP20	LRIS-4 * 12	LLR-25S
	5043856	5043849	16-20D25-OH2	●	●		2.0	16	16	120	20.5	4.5				
	5043930	5043948	20-25D34A-OH2	●	●		2.5	20	20	120	24.0	4.0				
3	5972567	5972989	CTDP _{R/L} 12-20D25-OH	●	●	25.4	2.0	12	12	100	20.5	8.5	0.15	CTDP20	LRIS-4 * 12	LLR-25S
	5972575	5973003	16-20D25-OH	●	●		2.0	16	16	100	20.5	4.5				

*Do not tighten clamp screw without installing insert as it may damage the insert pocket.

CTDP Series - Inserts

Shape	Item Number	Dimensions (mm)				PVD Coated Carbide							
		w	L	θ	r _e	TM4	Stock	QM3	Stock	DM4	Stock		
	CTDP20N	2.0	19.1	0°	0.05	5717012	●	5717004	●	5844972	●		
	20N02				0.2	5716998	●	5716980	●	5839352	●		
	20R6			6°	0.05	5717038	●	5717020	●	5844956	●		
	20R15				0.05	5717061	●	5717046	●	5844964	●		
	CTDP25N			2.5	21.2	0°	0.05	5750682	●	5750690	●	5846944	●
	25N02						0.2	5750708	●	5750732	●	5846936	●
25R6	6°	0.05	5750740			●	5750757	●	5852694	●			
25R15		0.05	5750765			●	5750773	●	5849377	●			

CTWP (CUT DUO EXTRA) Series Max. Cut-off Dia. ~ 42.0mm

CTWP

Screw accessible from both sides

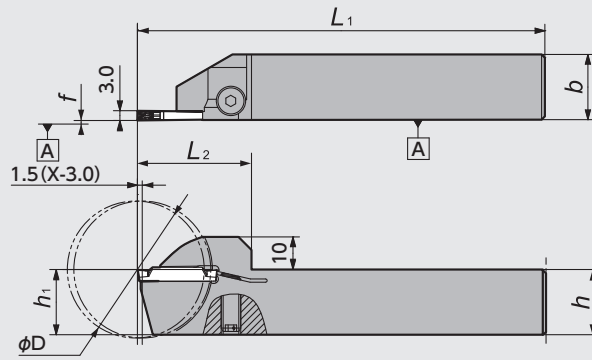

●Right-Hand style shown

Figure-1

CTWP-003

Screw accessible from both sides

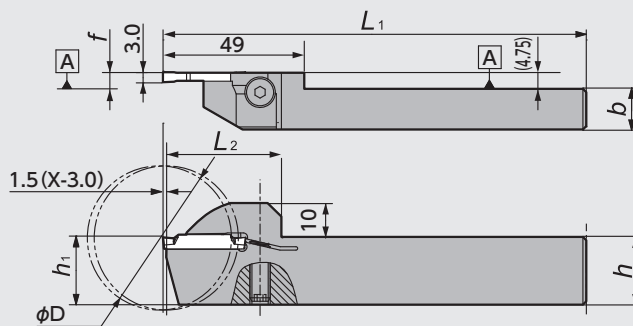

●Left-Hand style shown

Figure-2

CTWP Series - Toolholders

Figure	Code No.		Item Number	Stock		Max. Cut-off Dia (mm) ϕD	Dimensions (mm)						Gage insert	Spare Parts	
	R	L		R	L		h	b	L_1	h_1	f	L_2		Clamp Screw	Wrench
1	5973912	5973920	CTWP _{R/L} 2012K-3D42	●	●	42	20	12	125	20	0.25	35			
	5973870	5973904	2020K-3D42	●	●		20	20							
	5973854	5973862	2525M-3D42	●	●		25	25	150	25					
2		5012976	CTWPL2012K-3D42-003		★		20	12	125	20	5	44			

※Do not tighten clamp screw without installing insert as it may damage the insert pocket.

CTWP Series - Inserts

Shape	Item Number	Dimensions (mm)					PVD Coated Carbide	
		w	r_e	M	L	S	DM4	Stock
	GWPFM300N02-GT	3.0	0.2	2.2	24.5	(4.2)	5963251	●
	GWPFM300N04-GT		0.4				5963269	●

SS Tools for Cutting off

CTV Series Max. Cut-off Dia. ~ 45.0mm

CTV(-S)

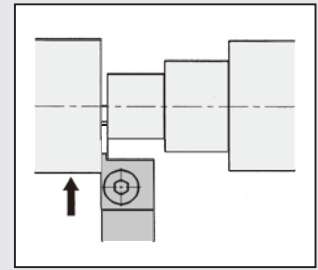
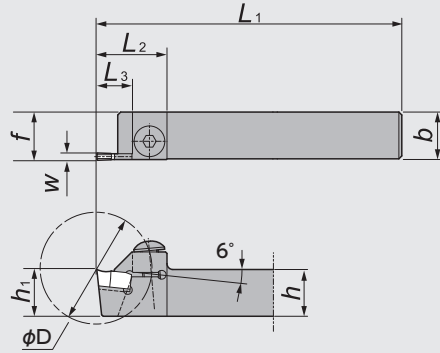

● Right-Hand style shown

Figure-1

CTV-X

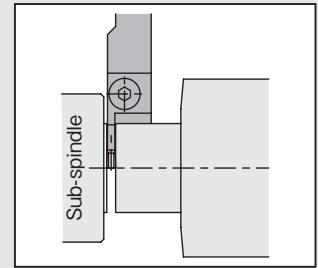
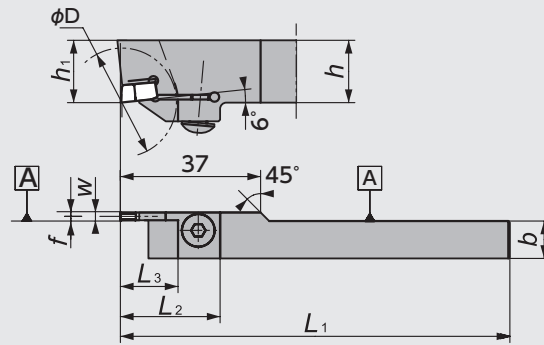

● Left-Hand style shown

Figure-2



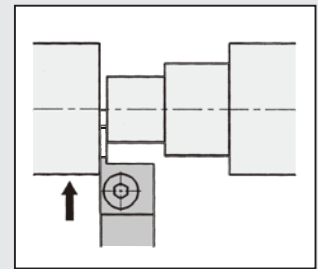
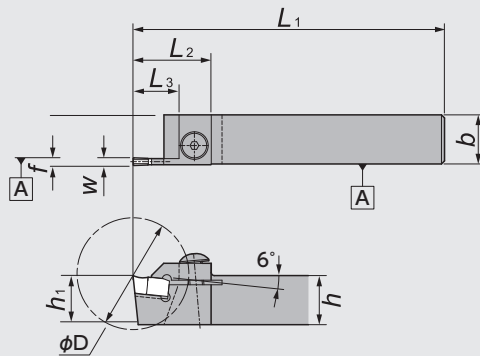



CTV-M(B)



● Right-Hand style shown

Figure-3

CTV Series - Toolholders

Figure	Code No.		Item Number	Stock		*1 Max. Cut-off Dia (mm) ϕD	Dimensions (mm)							Gage insert	Spare Parts							
	R	L		R	L		w	h	b	L ₁	h ₁	f	L ₂		L ₃	Clamp Screw	Wrench					
1	5904131		CTV ^{R/L} 16K25S	●		23.0	2.5	16	16	125	16	16.5	24	12.2								
	5904180		20K25S	●				20	20		20	20.5										
	5904149		16K30S	●			3.0	16	16		16	16.5										
	5904172		20K30S	●				20	20		20	20.5										
	5853619	5853627	16K25	●	●	35.0	2.5	16	16		16	16.5	32	18.5				CTV25	BS0620	LW-4		
	5853643	5853635	20K25	●	●			20	20		20	20.5						CTV25				
	5853593	5853601	16K30	●	●		3.0	16	16		16	16.5						CTV30				
	5853577	5853585	20K30	●	●			20	20		20	20.5						CTV30				
		5120423	5122197	1913L25	●	●	3.0	2.5	19		13	140	19	13.0				CTV25				
		5120431	5122189	1913L30	●	●		3.0	20		12	125	20	3.0				CTV30				
2		5595384	CTVL2012K30X-1		●																	
3	5177100		CTV ^{R/L} 16-25M	●		28.0	2.5	16	16	120	16	0.5	25.5	15								
	5185541		20-25M	●				20	20		20											
	5185566		16-30M	●			3.0	16	16		16							16.5			CTV30	BS0520
	5183314		20-30M	●				20	20		20											
	5162219	5184528	25-30B	●	●		45.0	2.5	25		25							150	25	34.5	23.5	

*1 : Max. cut-off diameter shows when X end point is 0.0. For more information, see page G67.

CTV Series - Inserts

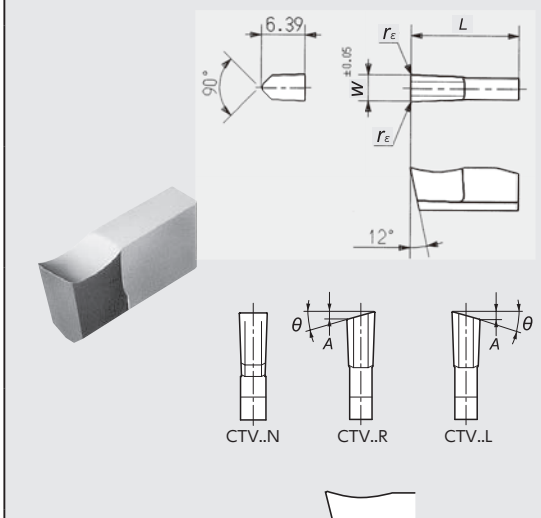
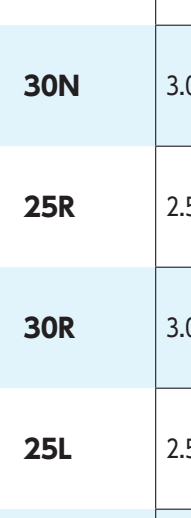
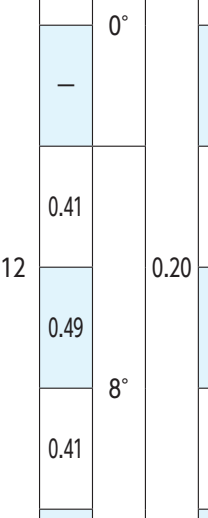
Shape	Item Number	Dimensions (mm)					PVD Coated Carbide			
		w	L	A	θ	r_ϵ	ZM3	Stock	QM3	Stock
 <p>Single-sided</p>	CTV25N	2.5	12	—	0°	0.20	5862248	●		
	30N	3.0		—			5864145	●	5972997	●
	25R	2.5	0.41	8°		5868633	●			
	30R	3.0	0.49		5866892	●				
	25L	2.5	0.41							
	30L	3.0	0.49		5129564	●				
 <p>Single-sided</p>	CTV30N038	3.0	12	—	0°	0.20	5524921	●		
 <p>Single-sided</p>	CTV25R00A	2.5	12	0.41	8°	0.05 max.	5162003	●		
	30R00A	3.0		0.49			5185327	●		
	25R00B	2.5	0.83	17°		5185178	●			
	30R00B	3.0	1.00		5183223	●				

※ 2 : All angles shown are obtained when insert is set in the holder.

- New Products
- Tool Materials / Selection Guide
- Micrograin Carbide, BIDEIMCS, PCD, PVD Coated Carbide, CBN and Ceramics
- Insert Item List
- General Turning Toolholders
- Unique Swiss Tooling
- Grooving / Side Turning
- Threading
- Shaper
- ID Tooling
- Application Introduction
- Endmills
- Rotating Tools
- Information
- Index