

JR Series

JRPMW

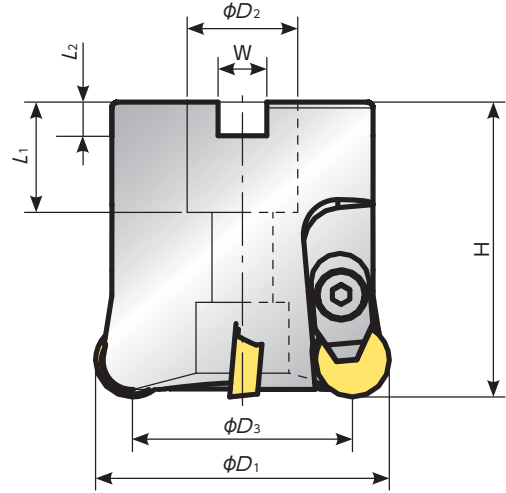

A.R. +5°
R.R. -2°30' ~ -5°



Shell type (for positive inserts) body

Code No.	Cutter P/N	Stock	N.O.B	ϕD_1	ϕD_3	Dimensions (mm)					Shim seat	Shim screw	Clamp	Clamping screw	Applicable insert	A.R.	R.R.	Weight (kg)
						H	ϕD_2	W	L_1	L_2								
5719935	JRPMW050S220R04	●	4	50	37.3	50	22	10.4	20	6.3	ARP42A	M3*8	AMS-5T	AOB-5S-T25	RPGN 1204	+5°	+5°	0.35
5726096	JRPMW063S220R04	●	4	63	50.3	50	22	10.4	20	6.3	5660659 Sales quantity 10pcs/case	5225453 Sales quantity 10pcs/case	5060132 Sales quantity 1pc/case	5660667 Sales quantity 10pcs/case		+5°	+5°	0.55
5719943	JRPMW080S254R05	●	5	80	67.3	50	25.4	9.5	25	6.0						+5°	+2°30'	0.87

● : Standard stock

JRNMW



A.R. -5°
R.R. -10°



Shell type (for negative inserts) body

Code No.	Cutter P/N	Stock	N.O.B	ϕD_1	ϕD_3	Dimensions (mm)					Clamp	Clamping screw	Applicable insert	Weight (kg)
						H	ϕD_2	W	L_1	L_2				
5719950	JRNMW050S220R03	●	3	50	37.3	50	22	10.4	20	6.3	AMS-6T 5060116 Sales quantity 1pc/case	AOB-6S-T30 5660683 Sales quantity 10pcs/case	RNGN 1207	0.42
5719968	JRNMW063S220R04	●	4	63	50.3									0.55
5719976	JRNMW080S254R05	●	5	80	67.3									25.4

● : Standard stock

JRPMW



A.R.+5°
R.R.-7°30'

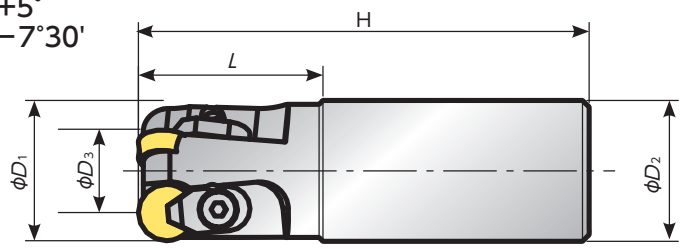

Shell type (for positive inserts) body

Code No.	Cutter P/N	Stock	N.O.B	ϕD_1	ϕD_2	ϕD_3	H	L_2	Clamp	Clamping screw	Applicable insert	Weight (kg)
5720719	JRPMW032E250R03	●	3	32	25	19.3	120	40	AMS-5T 5060132 Sales quantity 1pc/case	AOB-5S-T25 5660667 Sales quantity 10pcs/case	RPGN1204	0.42
5719919	JRPMW032E320R03	●		32	32	19.3						0.60
5719927	JRPMW040E320R03	●		40	32	27.3						0.72

● : Standard stock

Applicable inserts

Shape	NTK Part No.		Inscribed circle (mm)	Thickness (mm)	Nose radius (mm)	Material grade		
	P/N for metric type	Cutting edge process				SX7	SX9	WA1
	RNGN 120700	E002*	12.7	7.94	—		●	
		E004				●		
		T00520					●	●
		T00820				●		
		T01020						●
	RPGN 120400	E004	12.7	4.76	—	●		
		EX0004*					●	
		T00520						●
		T00820				●		
		T01020						●

※E002 • EX0004 : Round honing

● : Standard stock

Recommended cutting conditions													
Insert material grade	Work material	Cutting speed (m/min)						Feed rate (mm/tooth)					Depth of cut (mm)
		400	600	800	1000	1200	1400	0.05	0.08	0.10	0.12	0.15	
SX7/SX9	Heat-resistant alloy												~ 4 (mm)
WA1													

New Products
 Tool Materials / Selection Guide
 BIDEIMCS, PCD, CBN and ceramic
 Cermet
 PVD-coated Cermet
 Micro-grain Carbide, Carbide
 Insert Stock List
 Outside Machining Toolholders
 SS
 Grooving Tools
 Threading Tools
 Shaper
 Internal machining tool range
 Original Tools for Various Applications
 Indexable End Milling Tools
 Milling Cutters
 Technical Data
 Index