

Toolholders for DC.. Inserts

Y-SDJC

(Y-axis)

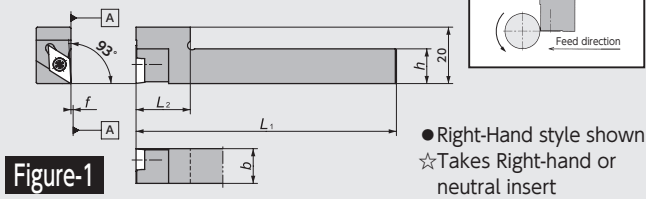

Figure-1

Y-SDNC

(Y-axis)

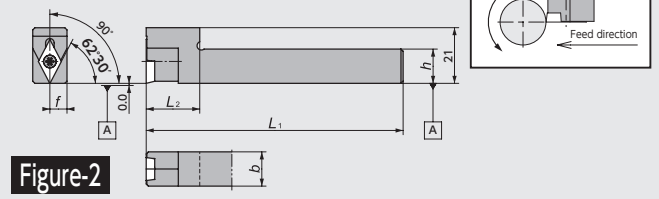

Figure-2

Y-SDJC-OH2

(Y-axis/
Coolant through)

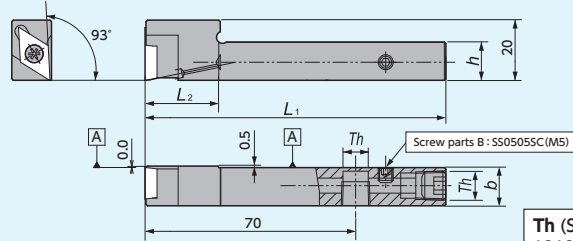
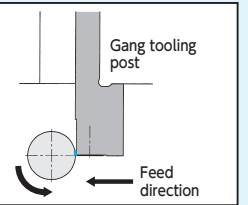

Figure-3



● Right-Hand style shown
☆ Takes Right-hand or neutral insert

Y-SDJC-OH

(Y-axis/
Coolant through)

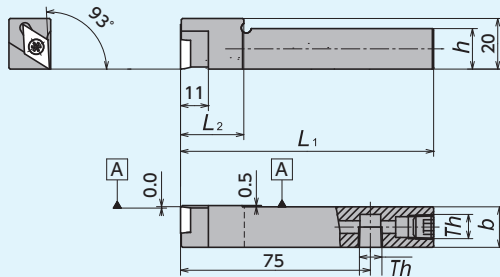
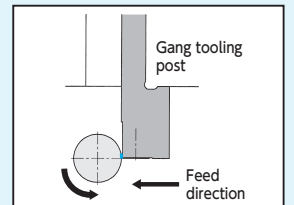

Figure-4



● Right-Hand style shown
☆ Takes Right-hand or neutral insert

DS-SDU

(DS Holder)

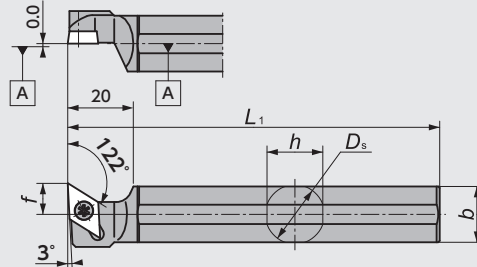
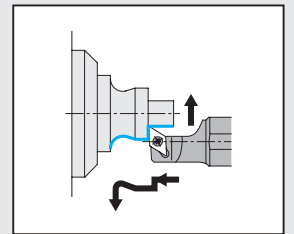

Figure-5



● Left-Hand style shown
☆ Takes Right-hand or neutral insert

DS-SDU-ACH

(DS-holder with Adjustable centerline height)

(Parts)		
Shank	Wedge	Screw for Wedge
φ16	ACH-W18 (5805601)	WS060415-003 (5795539)
φ19.05		
φ20		
φ22	ACH-W24 (5805619)	WS060419-004 (5799226)
φ25		
φ25.4		

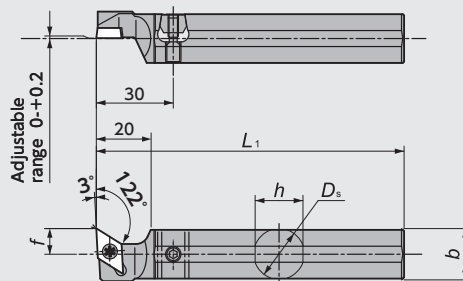
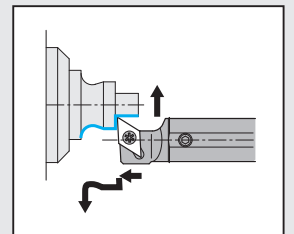

Figure-6



● Left-Hand style shown
☆ Takes Right-hand or neutral insert

DS-SDX

(DS Holder)

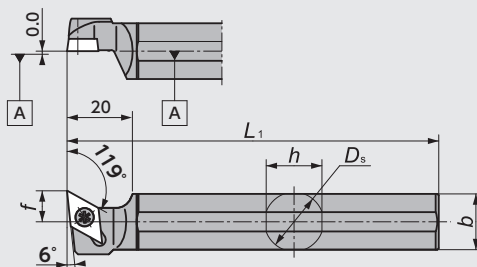
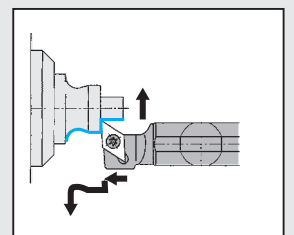
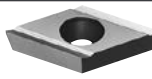



Figure-7



● Left-Hand style shown
☆ Takes Right-hand or neutral insert

DC.. Series - Toolholders

Figure	Code No.		Item Number	Stock			Dimensions (mm)					Gage insert 	Spare Parts			
	R	N		L	R	N	L	D _s	h	b	L ₁		f	L ₂	Clamp Screw 	Wrench (A)  (B)
1	5371646		Y-SDJCR _L 10-07S	●				10.0	10					DC0702 E29•42~43 TFD07 E44	LRIS-2.5*7	CLR-15S (A)
	5371661		12-07S	●				12.0	12				20			
	5926001		10-11S	●				10.0						DC11T3 E29•42~43 TFD11 E44	LRIS-4*10	LLR-25S -20*65 (B)
	5950431		10-11MS	●				10.0		120	0.0		22			
	5600671		12-11S	●				12.0	16				20			
	5950423		12-11MS	●				12.0					22			
	5890025		16-11S	●				16.0					20			
2	5479191		Y-SDNCRN12-11S	●				12.0	12					DC11T3 E29•42~43	LRIS-4*10	LLR-25S-20*65 (B)
	5485875		N16-11S	●				16.0	16				20			
3	5035209		Y-SDJCR _L 1212H11S-OH2	●				12	12	100			20	DC11T3 E29•42~43 TFD11 E44	LRIS-4*10	LLR-25S-20*65 (B)
4	5910575		Y-SDJCR _L 1212H11S-OH	●				12	12	100			20	DC11T3 E29•42~43 TFD11 E44	LRIS-4*10	LLR-25S-20*65 (B)
	5910583		1616H11-OH	●				16	16				25			
5	5348545		DS-SDUR _L 14F-07	●			14.000	13.0	13	80			6.0	DC0702 E29•42~43 TFD07 E44	LRIS-2.5*7	CLR-15S (A)
	5348107		15H-07	●			15.875			100						
	5520598		16F-07*	●			16.000	15.0	15	80						
	5341516		16X-07*	●						95						
	5278247		19-07	●			19.050	18.0	18	120						
	5520606		20X-07	●			20.000	19.0	19	95						
	5278239		20-07	●						120						
	5330758		22-07*	●			22.000	21.0	21							
	5601745		14F-11	●			14.000	13.0	13	80			10.0			
	5601737		16F-11*	●			16.000	15.0	15							
	5278262		19-11	●			19.050	18.0	18	120				11.0		
	5572730		19-11SPL	●						160						
	5520614		20X-11	●			20.000	19.0	19	95			10.0			
	5278254		20-11	●						120						
	5324025		22-11*	●			22.000	21.0	21					12.5		
	5638606		23-11-007	●			23.000	22.0	22	70						
	5483417		25-11MET	●			25.000			120				150		
5317136		25-11	●			25.400	24.0	24								
5713581		25-11SPL	●			25.400			150							
6	5805635		DS-SDUR _L 16F-11-ACH*	●			16.000	15.5	15	80			10.0			
	5805627		19-11-ACH	●			19.050	18.0	18							
	5799614		20-11-ACH	●			20.000	19.0	19	120						
	5799622		22-11-ACH*	●			22.000	21.0	21							
	5934021		25-11MET-ACH	●			25.000	24.0	24							
	5799648		25-11-ACH	●			25.400	24.0	24	150						
7	5462429		DS-SDXR _L 19-11	●			19.050	18.0	18	120			10.0			
	5520622		20X-11	●			20.000	19.0	19	95						
	5462437		20-11	●						120						
	5520697		25-11MET	●			25.000	24.0	24							
	5939335		32-11	●			32.000	30.0	30	150						

*Compatible with 16mm / 22mm round shank DS Series holders. DS-Sleeve → G103

SVJC-N-OH

(Coolant through)

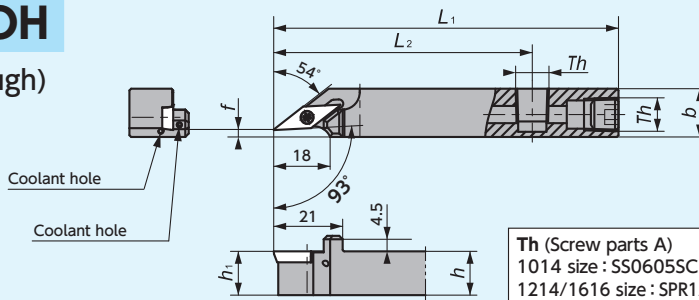

Th (Screw parts A)
1014 size : SS0605SC (M6×1.0)
1214/1616 size : SPR1/8 (Rc1/8)

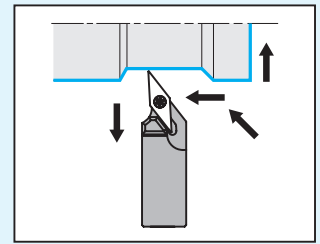

● Right-Hand style shown

Figure-7

Y-SVJC-OH

(Y-axis/
Coolant through)

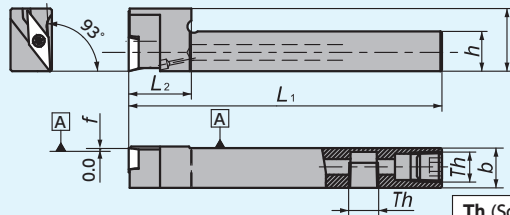

Th (Screw parts A)
1212/1616 size : SPR1/8 (Rc1/8)

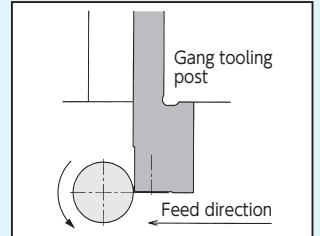

● Right-Hand style shown
☆ Takes Right-hand or neutral insert

Figure-8

VC.. Series - Toolholders

Figure	Code No.		Item Number	Stock		Dimensions (mm)						Gage insert	Spare Parts			
	R	L		R	L	h	b	L ₁	h ₁	f	L ₂		g	Clamp Screw	Wrench	
1	5304043	5304092	SVAC _{R/L} 1010X11N	●	●	10	10	120	10	0.0	—	—	VC _{□□□} 1103 E35•49~50	LRIS-2.5*7	CLR-15S (A)	
	5304050	5304076	1212X11N	●	●	12	12		12							
	5304068		1616X11N	●		16	16		16							
2	5473053	5473038	SVAC _{R/L} 1010X11N-1L	●	●	10	10	120	10	0.0	—	—	VCGT1102 E50	LRIS-2.5*7	CLR-15S (A)	
	5473061	5473046	1212X11N-1L	●	●	12	12		12							
3	5401724	5401708	SVAC _{R/L} 1010L13NW	●	●	10	10	140	10	0.0	25	—	VCGT1303 E49	LRIS-3*8	RLR-20S (B)	
	5401732	5401716	1212L13NW	●	●	12	12		12							
	5401740	5431077	1616M13NW	●	●	16	16		16							
4	5744768		SVAC _{R/L} 20-X11	●		20	20	120	20	25.0	30	—	VC _{□□□} 1103 E35•49~50	LRIS-2.5*7	CLR-15S (A)	
5	5474549		SVAC _{R/L} 2020M13W	●		20	20	150	20	25.0	30	—	VCGT1303 E49	LRIS-3*8	RLR-20S (B)	
6	5878012		SVJCR 0808H11N	●		8	8	100	8	0	19	2	VC _{□□□} 1103 E35•49~50 TFV E51	LRIS-2.5*7	CLR-15S (A)	
	5339940	5517750	SVJC _{R/L} 1010X11N	●	●	10	10	120	10	0.0	—	—				
	5339932	5517768	1212X11N	●	●	12	12		12							
	5339924	5517743	1616X11N	●	●	16	16		16							
7	5020482		SVJC _{R/L} 1014F11N-F02OH	●		10	14		80				10	2.0	55	—
	5000419		1214H11N-F02OH	●		12		100	12	75						
	5020508		1616H11N-F02OH	●		16		16	16							
8	5021209		Y-SVJC _{R/L} 1212H11S-OH	●		12	12	100	—	0	20	—	VC _{□□□} 1103 E35•49~50 TFV E51	LRIS-2.5*7	CLR-15S (A)	
	5021191		1616H11S-OH	●		16	16									

New Products
Tool Materials / Selection Guide
BIDEMCS, PCD, Micrograin Carbide, PVD Coated Carbide, CBN and Ceramics
Insert Item List
General Turning Toolholders
Unique Swiss Tooling
Grooving / Side Turning
Threading
Shaper
ID Tooling
Application Introduction
Endmills
Rotating Tools
Information
Index

Front Turning

Toolholders for VC.. Inserts

SVXC-N

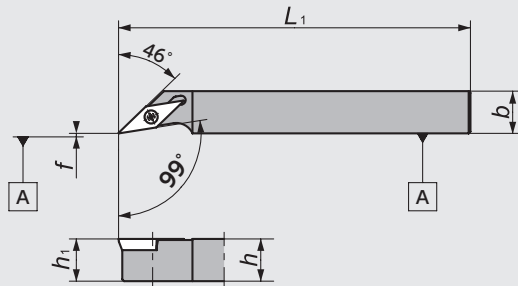
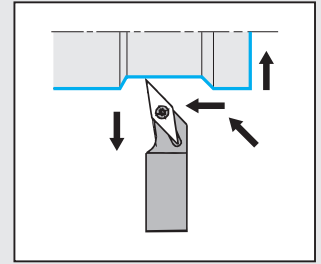

Figure-1



● Right-Hand style shown

Y-SVXCL

(Y-axis)

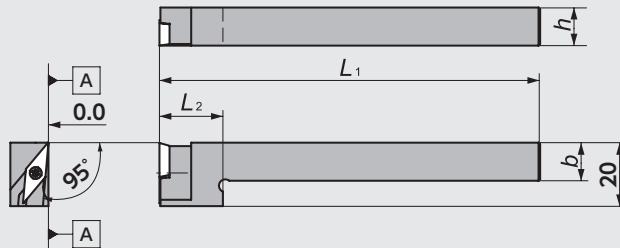
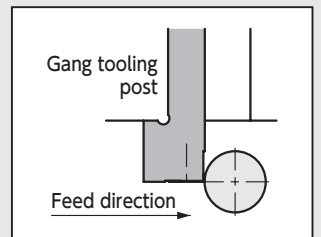

Figure-2



● Left-Hand style shown
☆ Takes Left-hand or neutral insert

SVQC

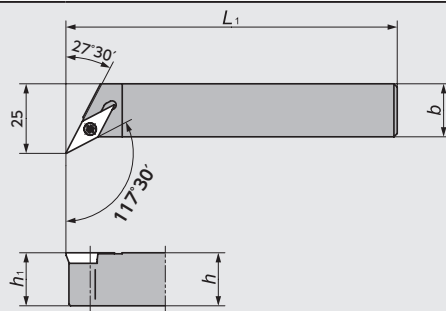
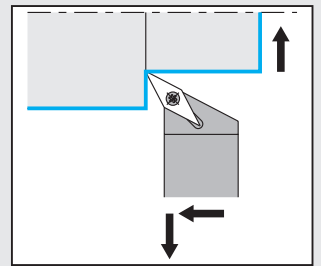

Figure-3



● Right-Hand style shown

SVVC-N

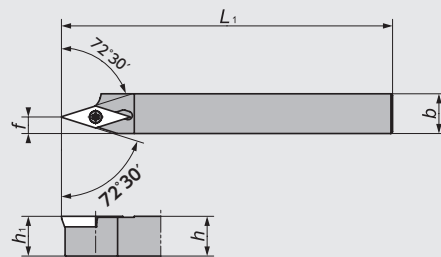
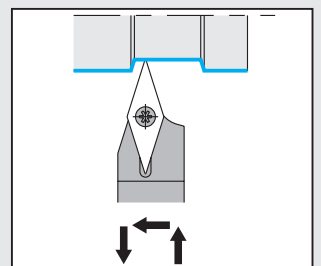

Figure-4



● Right-Hand style shown

SVVC-N

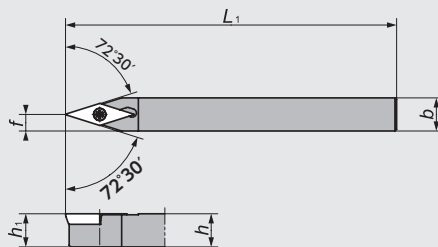
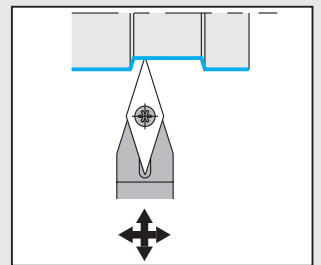

Figure-5



DS-SVX

(DS Holder)

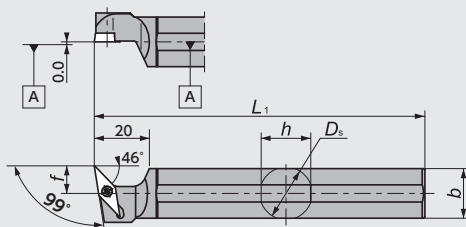
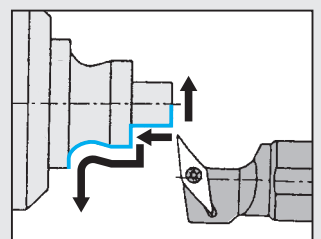

Figure-6



● Left-Hand style shown
☆ Takes Right-hand or neutral insert

CH-SVUC

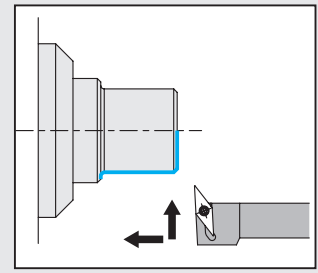
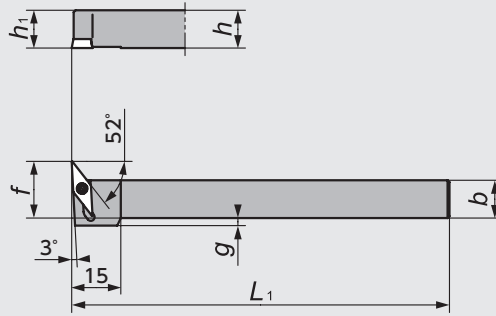

Figure-7

● Left-Hand style shown
☆ Takes Right-hand or neutral insert

New Products

Tool Materials / Selection Guide

Micrograin Carbide, BIDEIMCS, PCD, PVD Coated Carbide, CBN and Ceramics

Insert Item List

General Turning Toolholders

Unique Swiss Tooling

Grooving / Side Turning

Threading

Shaper

ID Tooling

Application Introduction

Endmills

Rotating Tools

Information

Index

VC.. Series - Toolholders

Figure	Code No.		Item Number	Stock		Dimensions (mm)								Gage insert	Spare Parts	
	R	L		R	L	D_s	h	b	L_1	h_1	f	L_2	g		Clamp Screw	Wrench
	N			N												
1	5393731	5415815	SVXC ^{R/L} 1012X11N	●	●	—	10	12	120	10	0.0	—	—	VC□□1103 E35•49~50	LRIS-2.5*7	CLR-15S
	5393749		1212X11N	●			12		12							
2		5917182	Y-SVXCL12-11S	●		—	12	12	120	—	—	20	—	VC□□1103 E35•49~50	LRIS-2.5*7	CLR-15S
3	5744776		SVQC ^{R/L} 20-X11	●		—	20	20	120	20	—	—	—		LRIS-2.5*7	CLR-15S
4	5523238		SVVC ^{R/L} 1212X11N	●		—	12	12	120	12	5	—	—		LRIS-2.5*7	CLR-15S
	5523212		1616X11N	●			16	16	16	16						
5	5877998		SVVCN0808H11N	●		—	8	8	100	8	4	—	—		LRIS-2.5*7	CLR-15S
	5461835		SVVCN1010X11N	●			10	10	120	10	5	—	—			
	5744792		N20-X11	●			20	20	20	20	10					
6	5601778		DS-SVX ^{R/L} 14F-11	●		14.000	13	13	80					VC□□1103 E35•49~50	LRIS-2.5*7	CLR-15S
	5418413		15H-11	●	15.875	15	15	100		10.0						
	5601752		16F-11*	●	16.000			80								
	5393756		19-11	●	19.050	18	18	120								
	5572722		19-11SPL	●				160		11.0						
	5520663		20X-11	●	20.000	19	19	95								
	5393764		20-11	●				120								
	5486675		22-11*	●	22.000	21	21	120		10.0						
	5953252		25-11MET	●	25.000	24	24	150								
	5486683		25-11	●	25.400											
7	5997077		CH-SVUC ^{R/L} 1010H11	●		—	10	10	100	10	18	—	2	VC□□1103 E35•49~50 TFV E51	LRIS-2.5*7	CLR-15S
	5995634		1212H11	●	—	12	12	100	12	20	—	0				
	5997085		1616H11	●	—	16	16	100	16	24	—	0				
	5997093		2020H11	●	—	20	20	100	20	28	—	0				

*Compatible with 16mm / 22mm round shank DS Series holders. DS-Sleeve → G103

TBP Series

TBP

Screw accessible from both sides

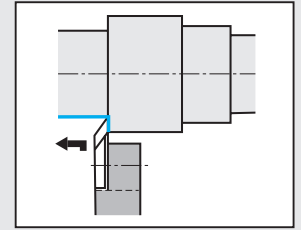
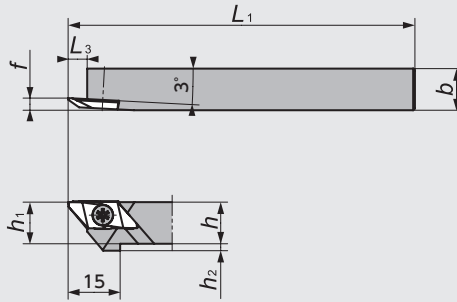

● Right-Hand style shown

Figure-1

TBP-OH2

(Coolant through)
Screw accessible from both sides

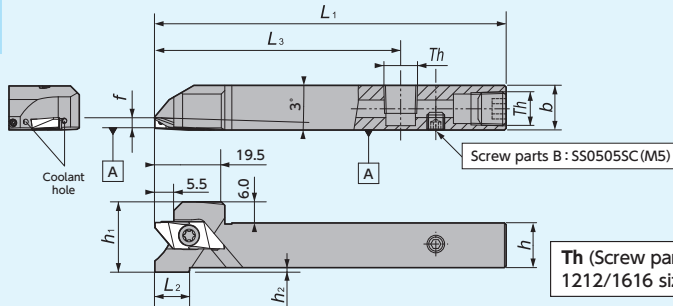

Th (Screw parts A)
1212/1616 size : SPR1/8(Rc1/8)

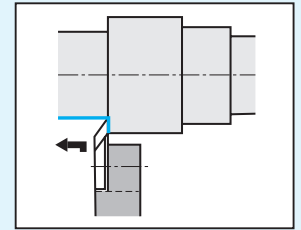

● Right-Hand style shown

Figure-2

TBP-OH

(Coolant through)
Screw accessible from both sides

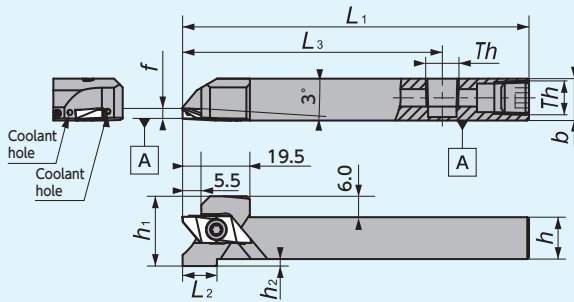

Th (Screw parts A)
1012 size : SS0605SC (M6×1.0)
1212/1616 size : SPR1/8(Rc1/8)

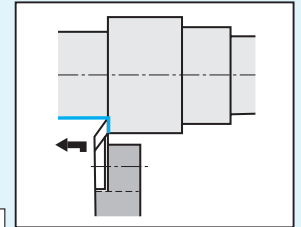

● Right-Hand style shown

Figure-3

Y-TBP

Screw accessible from both sides

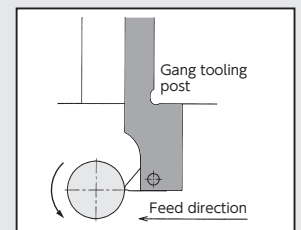
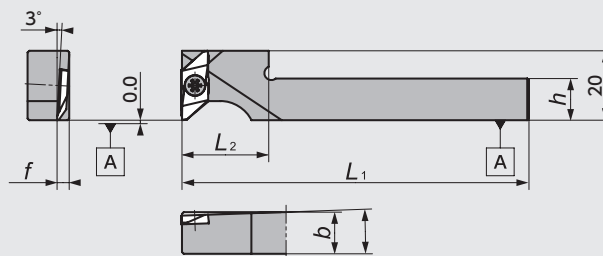

● Right-Hand style shown
☆ Takes Right-hand insert

Figure-4

Y-TBP-OH

(Coolant through)
Screw accessible from both sides

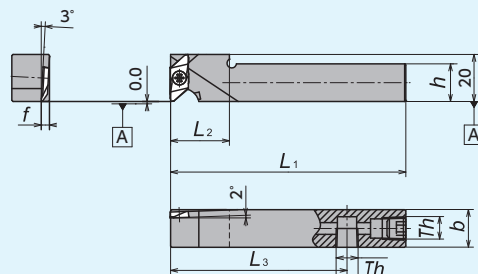

Th (Screw parts A)
1212/1616 size : SPR1/8(Rc1/8)

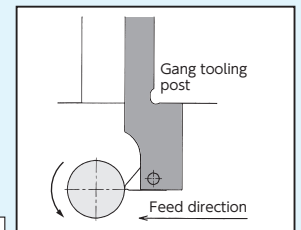

● Right-Hand style shown
☆ Takes Right-hand insert

Figure-5

DS-TBP

(DS Holder)

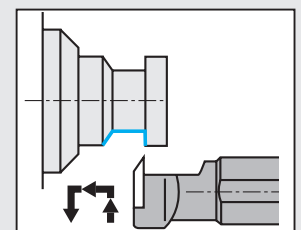
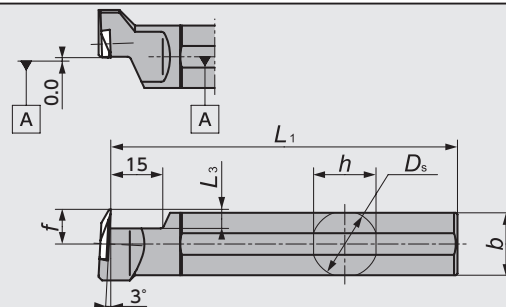

● Left-Hand style shown
☆ Takes Right-hand insert

Figure-6

TBP Series - Toolholders

Figure	Code No.		Item Number	Stock		Dimensions (mm)								Gage insert	Spare Parts			
	R	L		R	L	D_s	h	b	L_1	h_1	h_2	f	L_2		L_3	Clamp Screw		Wrench
																(A)	(B)	(A)
1	5133285	5133293	TBP $\frac{R}{L}$ 08	●	●	-	8	10	120	8	4	3.5	-	5.5	TBP	LRIS-4*10PW (A)	CLR-15S (A)	
	5873856		10H	●	●		10	10	100	10	2							
	5090436	5090444	10	●	●		12	12	85	12	0							
	5459771		12GX	●	●		13	13	120	13	0							
	5090451	5090469	12	●	●		16	16	100	16	0							
	5090477	5090485	13	●	●		16	16	120	16	0							
	5459789		16H	●	●													
5270822	5270830	16	●	●														
2	5037965		TBPR $\frac{R}{L}$ 12H-OH2	●	●	-	12	12	100	12	2	3.5	10	70	TBP	LRIS-4*12PW (A)	CLR-15S (A)	
	5043971		16X-OH2	●	●		16	16	120	16	0							
3	5925722		TBP $\frac{R}{L}$ 1012H-OH	●	●	-	10	12	100	10	4	3.5	19	75	TBP	LRIS-4*10PW (A)	CLR-15S (A)	
	5925730		12H-OH	●	●		12	12		12	2							
	5925748		16H-OH	●	●		16	16		16	0							
4	5371554		Y-TBP $\frac{R}{L}$ 10S	●	●	-	10	10	120	-	-	3.5	20	-	TBP	LRIS-4*10PW(A) LRIS-4*10PW(A) LRIS-4*12PW(A) LRIS-4*10PW(A)	CLR-15S (A)	
	5950399		10MS	●	●		10	10										22
	5371588		12S	●	●		12	12										20
	5950407		12MS	●	●		12	12										22
5	5911508		Y-TBP $\frac{R}{L}$ 12HS-OH	●	●	-	12	12	100	-	-	3.5	20	-	TBP	LRIS-4*12PW (A)	CLR-15S (A)	
	5911516		16H-OH	●	●		16	16										25
6		5540414	DS-TBP $\frac{R}{L}$ 19	●	●	19.050	18	18	120	-	-	10.0	-	5.5	TBP	LRIS-4*10 (B)	LLR-25S -20*65 (B)	
		5540422	20	●	●	20.000	19	19										
		5540430	25	●	●	25.400	24	24										150

TBP Series - Inserts

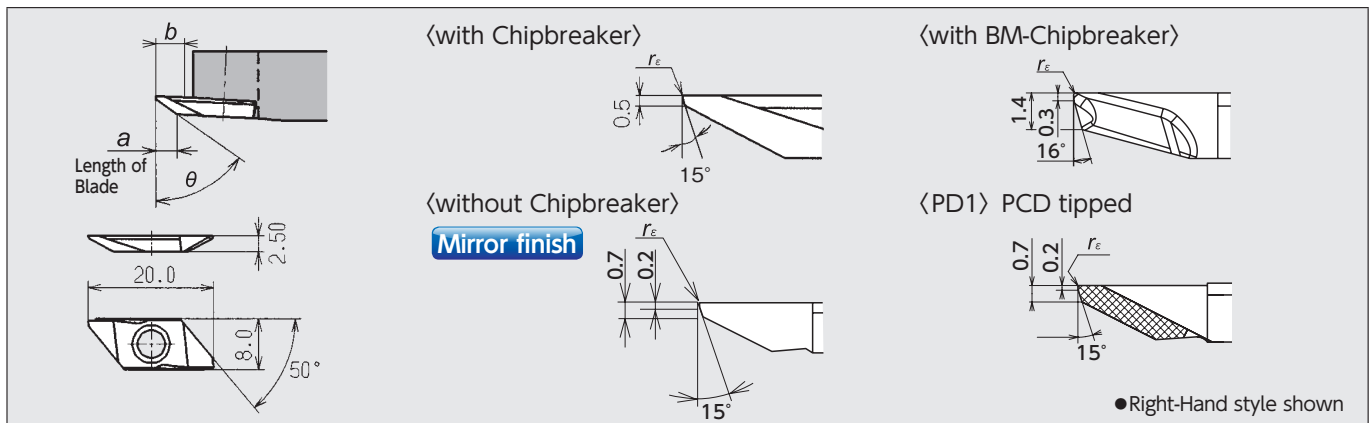

Item Number	Chip-breaker	Length of Blade a	Max Depth of cut b	Dimensions (mm)		PVD Coated Carbide												Carbide		PCD							
				θ	r_e	ST4		ZM3		QM3		VM1		TM4		DT4		DM4		KM1		PD1					
						R	Stock	R	Stock	L	Stock	R	Stock	R	Stock	L	Stock	R	Stock	R	Stock	R	Stock	R	Stock		
TBP72FR05-BM 72FR10M-BM 72FR20M-BM	Yes	3.5	72°	0.05	5039524	●																					
				0.08	5039532	●																					
				0.18	5039540	●																					
TBP55F $\frac{R}{L}$ 00 55F $\frac{R}{L}$ 10	Yes	3.0	55°	0.00		5090378	●	5090360	●				5270855	●													
				0.10		5090352	●	5090386	●				5294301	●													
TBP60F $\frac{R}{L}$ 00 60F $\frac{R}{L}$ 05 60F $\frac{R}{L}$ 10 60F $\frac{R}{L}$ 10M 60F $\frac{R}{L}$ 20 60F $\frac{R}{L}$ V	Yes	3.7	5.3	0.00		5090410	●	5090428	●	5494711	●	5275508	●			5710108	●	5850805	●								
				0.05																							
				0.10		5090402	●	5090394	●	5362488	●	5269949	●			5706114	●										
				※0.08						5486964	●	5476403	●							5850813	●						
				0.2													5738844	●									
60FRV00-P	No	4.8	60°	0.00		5345715	●					5264940	●	5264957	●												
60FRV05-P	No	4.0		0.05									5440680	●										5781745 (1 corner)	●		
60FRV10-P	No	4.8		0.10			5482690	●					5440698	●													
60FRV10-P	No	4.0		0.10																					5785118 (1 corner)	●	

※Inserts having "10M" the R code can be used for machining when the component drawing specifies that the radius is less than R=0.1
Note: All angles shown are obtained when insert is set in the holder.

New Products
Tool Materials / Selection Guide
Micrograin Carbide, BIDEINGS, PCD
PVD Coated Carbide, CBN and Ceramics
Insert Item List
General Turning Toolholders
Unique Swiss Tooling
Grooving / Side Turning
Threading
Shaper
ID Tooling
Application Introduction
Endmills
Rotating Tools
Information
Index

■ GTPA Series Best tool for Aluminum Spool Machining

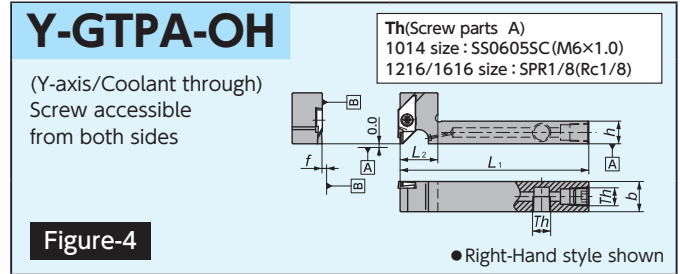
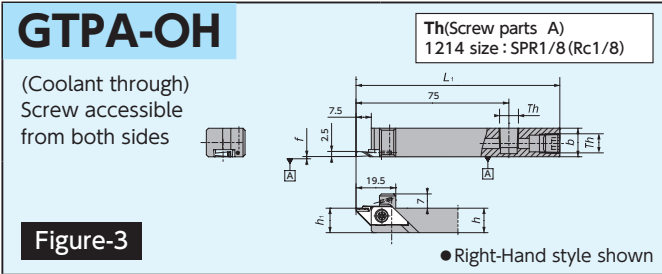
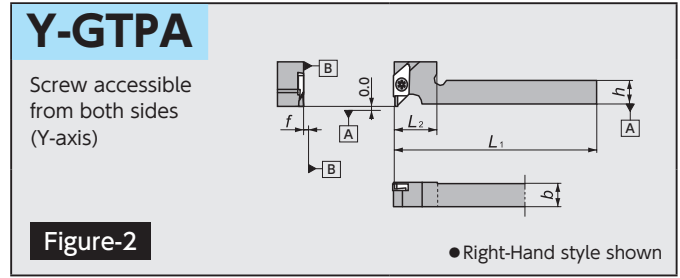
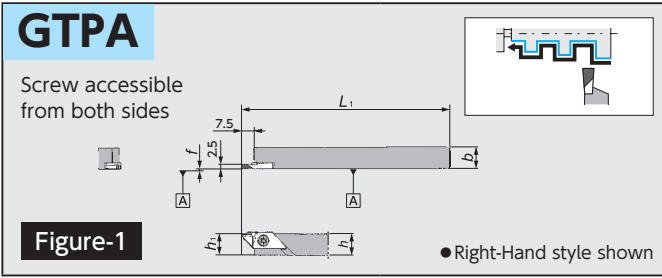

■ GTPA Series - Toolholders

Figure	Code No.		Item Number	Stock		Dimensions (mm)						Groove Width Range (mm) w	Gage insert 	Spare Parts	
	R	L		R	L	h	b	L ₁	h ₁	f	L ₂			Clamp Screw 	Wrench
1	5552401		GTPA 1010	●		10	10		10				GTPA	LRIS-4 * 10PW	CLR-15S
	5552419		1212	●		12	12	120	12	0.1	—				
	5577291		1616	●		16	16		16						
2	5563820		Y-GTPA 1216	●		12	16	120	—	0.1	20	2.0 } 2.5	GTPA	LRIS-4 * 12PW	CLR-15S
3	5912845		GTPA 1214H-OH	●		12	14	100	12	0.1	—				
4	5930185		Y-GTPA 1014FSS-OH	●		10	14	80			15	2.0 } 2.5	GTPA	LRIS-4 * 12PW	CLR-15S
	5911482		1216HS-OH	●		12	16	100	—	0.1	20				
	5911490		1616H-OH	●		16	16				25				

■ GTPA Series - Inserts

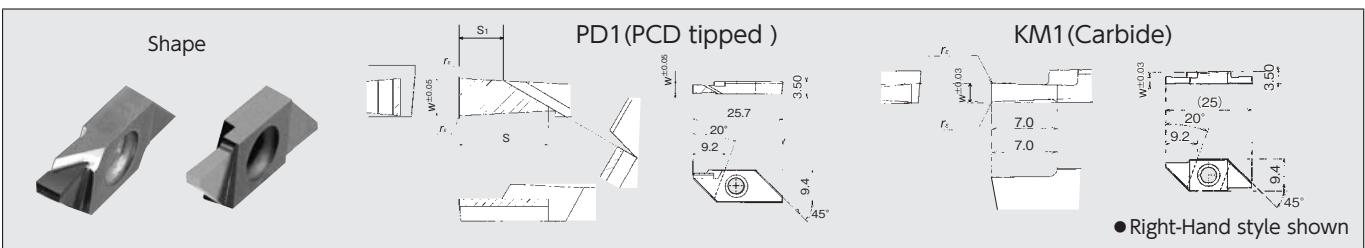

Item Number	Dimensions (mm)					PCD		Carbide		
	w	s	s ₁	r _e	Max Depth of cut	PD1	Stock	KM1	Stock	
GTPA20FRN01	2.0	6.0	4.0	R0.1 MAX	5.0	5552385	●			
20FRN01		—	—		6.0				5576525	●
20FRN01-SH		4.0	2.0		3.0	5966114	●			
GTPA25FRN01	2.5	6.0	3.0		5.0	5552393	●			
25FRN01		—	—		6.0				5576533	●
25FRN01-081		4.0	1.0		3.0	5561808	●			

Grooving / Side Turning

GTT Series

Y-GTT-OH

(Y-axis/Coolant through)
Screw accessible from both sides

Th(Screw parts A)
1212/1616 size:SPR1/8(Rc1/8)

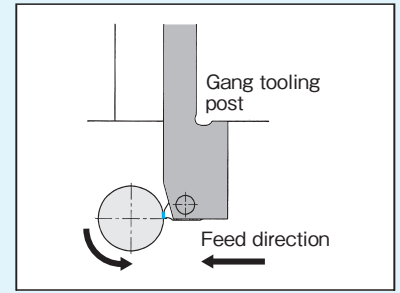
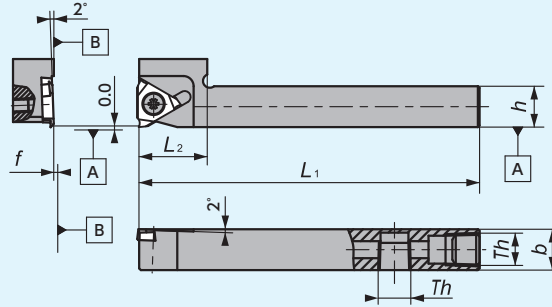

● Right-Hand style shown
☆ Takes Right-hand insert

Figure-1

Y-GTT

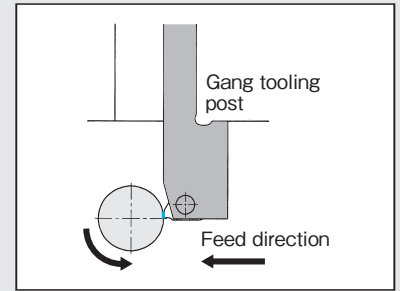
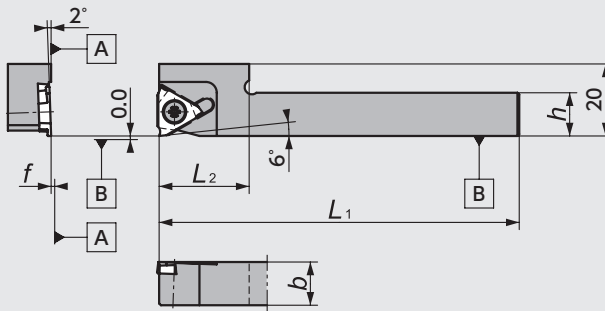

(Y-axis)
Screw accessible from both sides



● Right-Hand style shown
☆ Takes Right-hand insert

Figure-2

GTT Series - Toolholders

Figure	Code No.		Item Number	Stock		Dimensions (mm)								Groove Width Range (mm) w	Gage insert 	Spare Parts		
	R	L		R	L	h	b	L ₁	h ₁	f	L ₂	a _r	h ₂			Clamp Screw 	Wrench 	
1	5911466		Y-GTT [®] ¼12H00S-OH	●		12	12						20		GTMH32 GTMX32 H22~25	LR-S-4* 10PW	CLR-15S	
	5911474		Y-GTT [®] ¼16H00-OH	●		16	16	100	—	0			25					0.30 } 3.00 ※1
2	5371604		Y-GTT [®] ¼10S	●			10	10					20		TBMH32 G61	LR-S-4* 10PW	CLR-15S	
	5950415		10MS	●									22					0.30 } 3.00 ※1
	5371620		12S	●				120	—	0			20					
	5950472		12MS	●		12	12						22					