

CTPS Series

CTPS

Best for up to 10mm diameter material

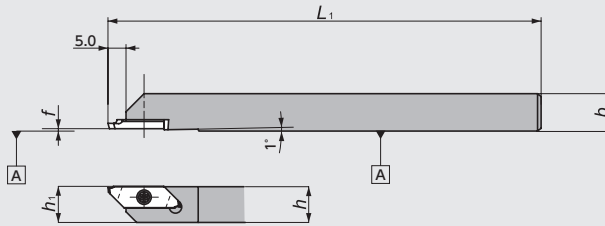

Figure-1

● Right-Hand style shown

CTPSR-SUB

Best for up to 4mm diameter material

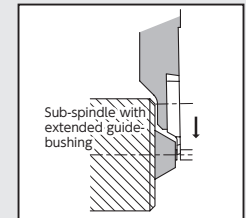
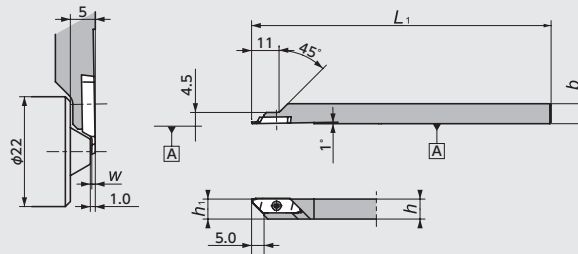

Figure-2

● Right-Hand style shown

CTPS Series - Toolholders

Figure	Code No.	Item Number	Stock	Max. Cut-off Dia (mm) ϕD	Dimensions (mm)					Gage insert	Spare Parts	
					h	b	L_1	h_1	f		Clamp Screw	Wrench
1	5346572	CTPSR10 R12	●	10.0	10	10	120	10	0.0			
	5397187		●		12	12		12				
2	5486717	CTPSR08-SUB04	●	4.0	8	8	120	8	—	CTPS-001	LRIS-2.5*4.5	CLR-15S

☆ All the inserts can use the same toolholder CTPS series → G98

CTPS Series - Inserts

CTPS

Shape	Item Number	Chip-breaker	*1 Max. Cut-off Dia (mm) ϕD	Dimensions (mm)				PVD Coated Carbide			
				w	A	θ *2	r_e	ZM3	Stock	VM1	Stock
(with Chipbreaker) ● Right-Hand style shown	CTPS12FR	Yes	4.0	1.2	0.37	16°	0.05	5346275	●	5362587	●
	15FR		5.0	1.5	0.46			5346267	●	5362595	●
	18FR		8.5	1.8	0.55			5346283	●	5362603	●
	20FR		10.0	2.0	0.61			5374210	●	5374194	●
(without Chipbreaker) Mirror finish ● Right-Hand style shown	CTPS12FRV	No	4.0	1.2	0.47	20°	0.0	5346937	●	5362611	●
	15FRV		5.0	1.5	0.58			5346929	●	5362629	●
	18FRV		8.5	1.8	0.70			5346945	●	5362637	●
	20FRV		10.0	2.0	0.77			5374202	●	5374228	●

*1: Max. cut-off diameter shows when X end point is 0.0. For more information, see page G67.

*2: All angles shown are obtained when insert is set in the holder.

CTPS-001

Shape	Item Number	Chip-breaker	*1 Max. Cut-off Dia (mm) ϕD	Dimensions (mm)				PVD Coated Carbide	
				w	A	θ *2	r_e	ZM3	Stock
 ● Right-Hand style shown	CTPS07FRN-001	Yes	4.0	0.7	0.23	16°	0.05	5460670	●
	CTPS07FR-001							5441852	●
	CTPS07FRV-001	No	0.28	20°	0.0	5441860	●		

*1: Max. cut-off diameter shows when X end point is 0.0. For more information, see page G67.

*2: All angles shown are obtained when insert is set in the holder. **G73**

SS Tools for Cutting off

CTP Series Max. Cut-off Dia. ~ 12.0mm

CTP

Screw accessible from both sides

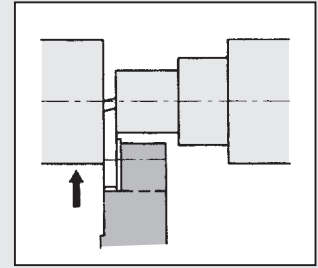
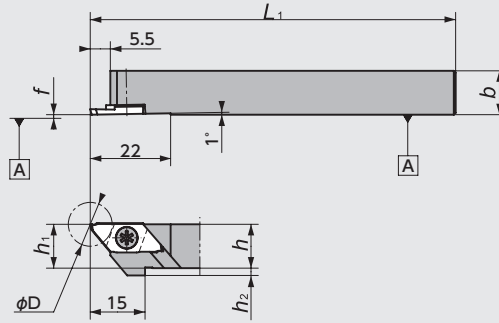

● Right-Hand style shown

Figure-1

CTP-OH2

(Coolant through)
Screw accessible from both sides

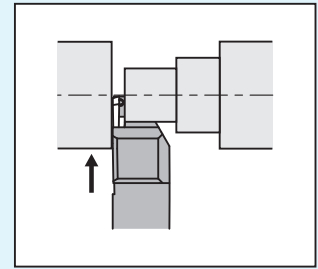
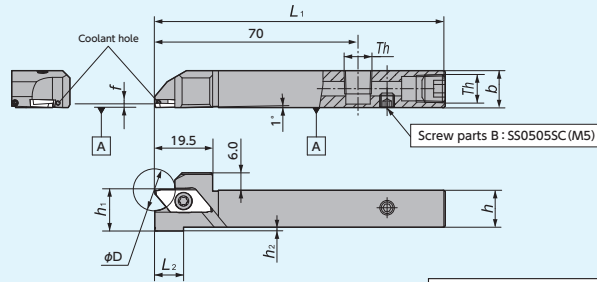

● Right-Hand style shown

Figure-2 ● Left-Hand holders are designed for Right-Hand machines

Th (Screw parts A)
1212 size : SPR1/8 (Rc1/8)

CTP-OH

(Coolant through)
Screw accessible from both sides

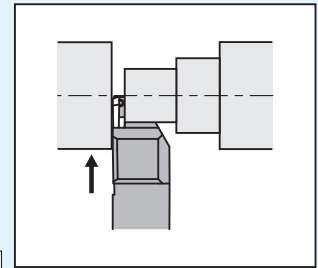
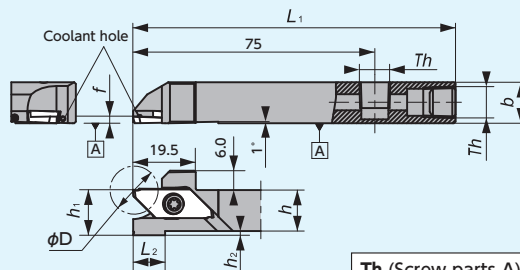

● Right-Hand style shown

Figure-3 ● Left-Hand holders are designed for Right-Hand machines

Th (Screw parts A)
1012 size : SS0605SC (M6x1.0)
1212/1616 size : SPR1/8 (Rc1/8)

CTPR-SUB

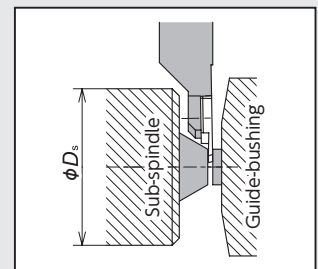
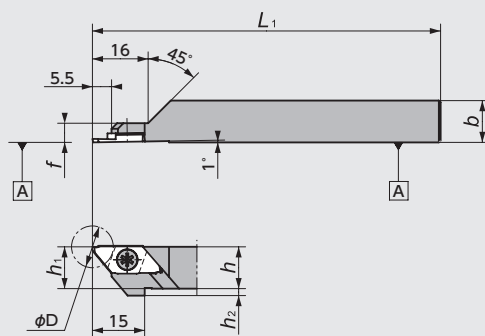

● Right-Hand style shown

Figure-4

ϕD_s
CTPR-SUB : $\phi 30\text{mm}$

CTPL-SUB

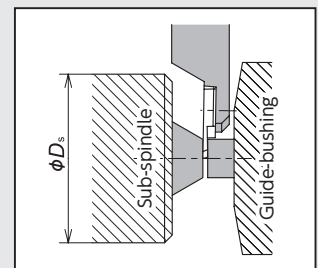
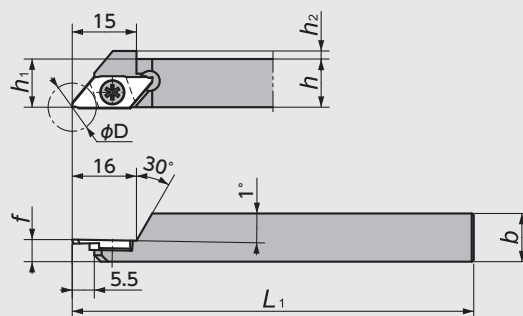





● Left-Hand style shown

Figure-5

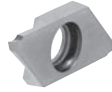
ϕD_s
CTPL-SUB : $\phi 30\text{mm}$

CTP Series - Toolholders

Figure	Code No.		Item Number	Stock		Max. Cut-off Dia (mm) ϕD	Dimensions (mm)						Gage insert 	Spare Parts			
	R	L		R	L		h	b	L ₁	h ₁	h ₂	L ₂		f	Clamp Screw		Wrench
															(A)	(B)	(A) 
1	5131362	5131354	CTP^{R/L} 08	●	●	12.0※	8		120	8	4	0	0.0	CTP-CX CTP CTP-X CTPX G76~79	 LRIS-4*10PW (A)		(A)  (B)
	5873849	5893458	10H	●	●		10	10	100	10	2	0					
	5089644	5089636	10	●	●				120								
	5459730	5459748	12GX	●	●		12	12	85	12							
	5089651	5089669	12	●	●				120								
	5089677	5089685	13	●	●		13	13		13	0	0					
	5459755		16H	●			16	16	100	16							
	5183496	5183504	16	●	●				120								
2	5037874	5037866	CTP^{R/L} 12H-OH2	●	●	12.0※	12	12	100	12	2	10	1.5※	CTP-CX CTP CTP-X CTPX G76~79	LRIS-4*12PW (A)	CLR-15S (A)	
3	5921853	5921861	CTP^{R/L} 1012H-OH	●	●	12.0※	10	12		12	4	19	1.5※	CTP-CX CTP CTP-X CTPX G76~79	LRIS-4*12PW (A)	CLR-15S (A)	
	5918651	5918040	12H-OH	●	●		12	12	100		2	10					
	5921879	5921887	16H-OH	●	●		16	16		16	0	0					
4	5571831		CTPR 08-SUB	●		12.0※	8	8	120	8	4	0	5.5	CTP-CX CTP-FR (N) (V) (NV) CTP-FRX (FRNX) CTPX-FR (N) G76~79	LRIS-4*5 (B)	LLR-25S (B)	
	5607999		08J-SUB	●			110										
	5391610		10F-SUB	●			10	10	80	10	2	0					
	5605282		10KX-SUB	●			120										
	5474580		12GX-SUB	●			12	12	85	12	0	0					
	5391628		12-SUB	●			120										
5		5570791	CTPL 08-SUB	●		12.0※	8	8	120	8	4	0	5.5	CTP-CX CTP-FLK CTP-FLKV CTP-FLN CTP-FLNV CTPX-FLN CTPX-FLNX G76~79	LRIS-4*5 (B)	LLR-25S (B)	
		5608005	08J-SUB	●			110										
		5499389	10GX-SUB	●			10	10	85	10	2	0					
		5482534	12GX-SUB	●			12	12		12	0	0					

※ Would be changed by insert.

New Products
 Tool Materials / Selection Guide
 Micrograin Carbide, PCD, PVD Coated Carbide
 Insert Item List
 General Turning Toolholders
 Unique Swiss Tooling
 Grooving / Side Turning
 Threading
 Shaper
 ID Tooling
 Application Introduction
 Endmills
 Rotating Tools
 Information
 Index

CTP Series - Inserts (Ground Chipbreaker)

Shape	Item Number	*1 Max. Cut-off Dia (mm) ϕD	Dimensions (mm)				PVD Coated Carbide					
			w	A	**2 θ	r_ϵ	ZM3	Stock	VM1	Stock	DT4	Stock
	CTP05FR-SH	5.0	0.5	0.17	16°	0.05	5788732	●				
	07FR	8.0	0.7	0.23			5126255	●				
	10FR	12.0	1.0	0.32			5089594	●			5847868	●
	10FR-SH	7.0	1.0	0.32			5788724	●			5847876	●
	13FR	12.0	1.3	0.40			5988704	●			5988738	●
	15FR	12.0	1.5	0.46			5089602	●	5284690	●		
	20FR	12.0	2.0	0.61			5125521	●	5432372	●		
	CTP05FRN-SH	5.0	0.5	–	0°	0.05	5788799	●				
	10FRN	12.0	1.0	–			5133327	●		5847884	●	
	10FRN-SH	7.0	1.0	–			5788757	●		5847892	●	
	13FRN	12.0	1.3	–			5988712	●		5988746	●	
	15FRN	12.0	1.5	–			5133301	●	5306543	●		
	20FRN	12.0	2.0	–			5133335	●	5272224	●		
	CTP10FRK	11.0	1.0	0.32	16°	0.05	5131412	●				
	13FRK	12.0	1.3	0.40			5988720	●		5988761	●	
	15FRK	11.0	1.5	0.46			5131404	●				
	20FRK	11.0	2.0	0.61			5131388	●				
	CTP07FL	8.0	0.7	0.23	16°	0.05	5126263	●				
	10FL	12.0	1.0	0.32			5089586	●				
	13FL	12.0	1.3	0.40			5988779	●			5988795	●
	15FL	12.0	1.5	0.46			5089610	●				
	20FL	12.0	2.0	0.61			5125513	●				
	CTP05FLN-SH	5.0	0.5	–	0°	0.05	5788773	●				
	10FLN	12.0	1.0	–			5133350	●		5847900	●	
	10FLN-SH	7.0	1.0	–			5788765	●		5847918	●	
	13FLN	12.0	1.3	–			5988787	●		5988811	●	
	15FLN	12.0	1.5	–			5133319	●	5378526	●		
	20FLN	12.0	2.0	–			5133343	●	5273008	●		
	CTP05FLK-SH	5.0	0.5	0.17	16°	0.05	5788781	●				
	10FLK	11.0	1.0	0.32			5131420	●		5847926	●	
	10FLK-SH	7.0	1.0	0.32			5788807	●		5847934	●	
	13FLK	11.0	1.3	0.40			5926399	●		5988837	●	
	15FLK	11.0	1.5	0.46			5131396	●	5328240	●		
	20FLK	11.0	2.0	0.61			5131370	●	5280722	●		
	15FLKB	11.0	1.5	0.46			5645254	●				

*1 : Max. cut-off diameter shows when X end point is 0.0. For more information, see page G67.
 *2 : All angles shown are obtained when insert is set in the holder.

CTP Series - Inserts (Without Chipbreaker) Mirror finish

Shape	Item Number	*1 Max. Cut-off Dia (mm) ϕD	Dimensions (mm)				Carbide		PVD Coated Carbide					
			w	A	**2 θ	r_ϵ	KM1	Stock	ZM3	Stock	VM1	Stock	DT4	Stock
<p>• Right-Hand style shown</p>	CTP10FRV	12.0	1.0	0.40	20°	0.0	5576079	●	5255708	●	5264841	●	5847942	●
	15FRV		1.5	0.58			5576087	●	5255682	●	5264858	●		
	20FRV		2.0	0.77			5576095	●	5255666	●	5264866	●		
	CTP15FRNV		1.5	—	0°		5576111	●						
	20FRNV		2.0	—			5576020	●						
	CTP10FLV		12.0	1.0	0.40		20°	0.0			5255641	●	5264882	●
	15FLV	1.5		0.58					5255625	●	5264890	●		
	20FLV	2.0		0.77					5255609	●	5264908	●		
	CTP15FLNV	1.5		—	0°	5576012	●							
	20FLNV	2.0		—		5576004	●							
	CTP15FLKV	11.0		1.5	0.58	20°	5576103		●		5264874	●		
	20FLKV		2.0	0.77					5392691	●				

※ 1: Max. cut-off diameter shows when X end point is 0.0. For more information, see page G67.
 ※ 2: All angles shown are obtained when insert is set in the holder.

CTP Series - Inserts (Ground Chipbreaker : cost advantage style)

Shape	Item Number	*1 Max. Cut-off Dia (mm) ϕD	Dimensions (mm)				PVD Coated Carbide					
			w	A	**2 θ	r_ϵ	ZM3	Stock	QM3	Stock	DT4	Stock
<p>• Right-Hand style shown</p>	CTPX15FR	12.0	1.5	0.46	16°	0.05	5334909	●	5535729	●	5827514	●
	20FR		2.0	0.61			5334834	●	5535745	●	5850169	●
	CTPX15FRN		1.5	—	0°				5535711	●	5850193	●
	20FRN		2.0	—					5535737	●	5850144	●
	CTPX15FL		1.5	0.46	16°						5850227	●
	20FL		2.0	0.61							5850185	●
	CTPX15FLN	1.5	—	0°					5535653	●	5850201	●
	20FLN	2.0	—						5535638	●	5830468	●
	CTPX15FLK	11.0	1.5	0.46	16°				5535646	●	5850219	●
	20FLK		2.0	0.61					5535620	●	5850177	●

※ 1: Max. cut-off diameter shows when X end point is 0.0. For more information, see page G67.
 ※ 2: All angles shown are obtained when insert is set in the holder.

CTP Series - Inserts (Ground Chipbreaker : Strengthen edge with land style)

Shape	Item Number	*1 Max. Cut-off Dia (mm) ϕD	Dimensions (mm)				PVD Coated Carbide	
			w	A	*2 θ	r_ϵ	ZM3	Stock
<p>● Right-Hand style shown</p>	CTP15FRX	12.0	1.5	0.46	16°	0.05	5360847	●
	20FRX		2.0	0.61			5360839	●
	CTP15FRNX		1.5	—	0°		5360813	●
	20FRNX		2.0	—			5360821	●

* 1 : Max. cut-off diameter shows when X end point is 0.0. For more information, see page G67.
 * 2 : All angles shown are obtained when insert is set in the holder.

CTP Series - Inserts (Ground Chipbreaker : Strengthen edge with land style)

Shape	Item Number	*1 Max. Cut-off Dia (mm) ϕD	Dimensions (mm)				PVD Coated Carbide	
			w	A	*2 θ	r_ϵ	ST4	Stock
<p>● Right-Hand style shown</p>	CTP10FR-TH	12.0	1.0	0.32	16°	0.05	5038823	●
	CTP15FR-TH		1.5	0.46			5040118	●
	CTP20FR-TH		2.0	0.61			5040167	●
	CTP10FRN-TH		1.0	—	0°		5038849	●
	CTP15FRN-TH		1.5	—			5040134	●
	CTP20FRN-TH		2.0	—			5040183	●
	CTP10FLK-TH	11.0	1.0	0.32	16°		5038856	●
	CTP15FLK-TH		1.5	0.46			5040142	●
	CTP20FLK-TH		2.0	0.61			5040191	●
	CTP10FLN-TH	12.0	1.0	—	0°		5038864	●
	CTP15FLN-TH		1.5	—			5040159	●
	CTP20FLN-TH		2.0	—			5040209	●

* 1 : Max. cut-off diameter shows when X end point is 0.0. For more information, see page G67.
 * 2 : All angles shown are obtained when insert is set in the holder.

New Products
 Tool Materials / Selection Guide
 Micrograin Carbide, BIDEIMS, PCD, CBN and Ceramics
 PVD Coated Carbide
 Insert Item List
 General Turning Toolholders
 Unique Swiss Tooling
 Grooving / Side Turning
 Threading
 Shaper
 ID Tooling
 Application Introduction
 Endmills
 Rotating Tools
 Information
 Index

CTPA Series Max. Cut-off Dia. ~ 16.0mm

CTPA

Screw accessible from both sides

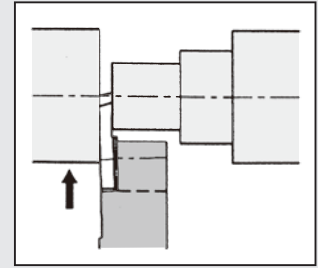
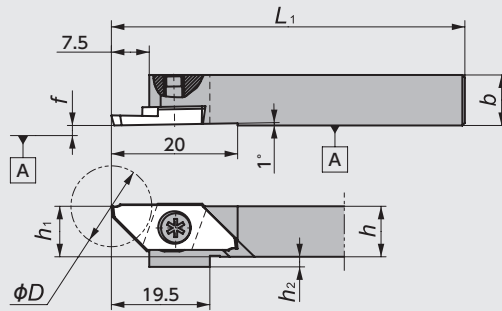

● Right-Hand style shown

Figure-1

CTPA-OH2

□12 : CTPA $\frac{R}{L}$ 12H-OH2

□16 : CTPA $\frac{R}{L}$ 16X-OH2

(Coolant through)

Screw accessible from both sides

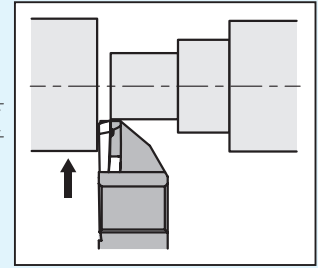
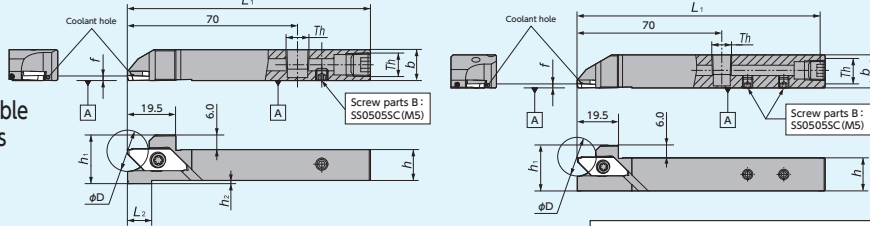

● Right-Hand style shown

Figure-2 ● Left-Hand holders are designed for Right-Hand machines

Th (Screw parts A)
1212/1616 size : SPR1/8(Rc1/8)

CTPA-OH

(Coolant through)
Screw accessible from both sides

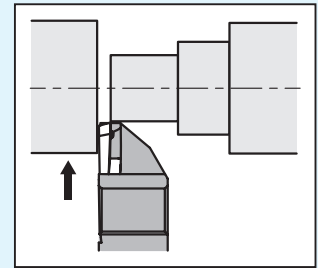
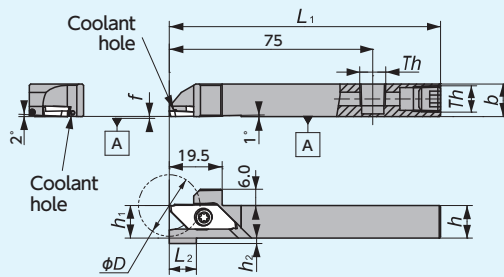

● Right-Hand style shown

Figure-3 ● Left-Hand holders are designed for Right-Hand machines

Th
□12, □16 : Rc1/8 (PT1/8)

CTPAR-SUB

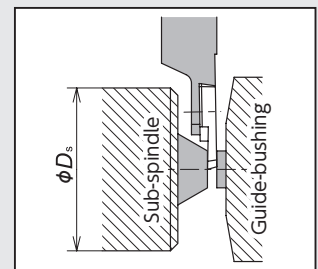
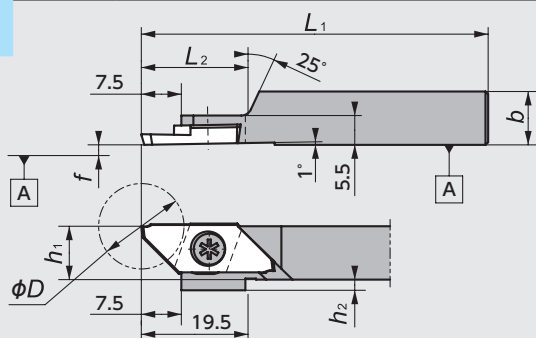

● Right-Hand style shown

Figure-4

ϕDs
CTPAR-SUB : ϕ36mm

CTPAL-SUB

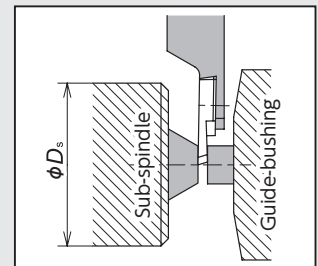
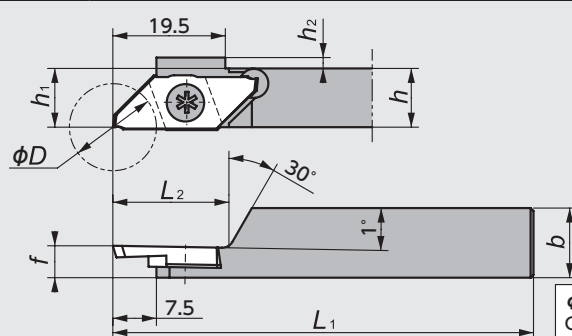



● Left-Hand style shown

Figure-5

ϕDs
CTPAL-SUB : ϕ36mm

CTPA Series - Toolholders

Figure	Code No.		Item Number	Stock		Max. Cut-off Dia (mm) ϕD	Dimensions (mm)							Gage insert 	Spare Parts		
	R	L		R	L		h	b	L ₁	h ₁	h ₂	L ₂	f		Clamp Screw		Wrench
															(A)	(B)	(A)
1	5199187	5199153	CTPA $\frac{R}{L}$ 10	●	●	16.0 ※	10	10	120	10	2	—	0.0	 CTPA (Cut-off) G82~84 TBPA (Back Turning) G55	LRIS-4*10PW (A)	 CLR-15S (A)	
	5016209	5016217	12GX	●	●		12	12	85	12	0				LRIS-4*12PW (A)		
	5199195	5199161	12	●	●		16	16	16	16	0				LRIS-4*10 (B)		LLR-25S (B)
	5199203	5199179	16	●	●		20	20	80	20	0						
	5459540	5459557	20F	●	●												
2	5037932	5037924	CTPA $\frac{R}{L}$ 12H-OH2	●	●	16.0 ※	12	12	100	12	2	10	2.0※	CTPA (Cut-off) G82~84	LRIS-4*12PW (A)	CLR-15S (A)	
	5043872	5043864	16X-OH2	●	●		16	16	120	16	0	0	2.0※				
3	5931522	5931530	CTPA $\frac{R}{L}$ 12H-OH	●	●	16.0 ※	12	12	100	12	2	10	2.0※	CTPA (Cut-off) G82~84	LRIS-4*12PW (A)	CLR-15S (A)	
	5931548	5931563	16H-OH	●	●		16	16		16	0	0	2.0※				
4	5600770		CTPAR10GX-SUB	●		16.0 ※	10	10	85	10	2	20	0.0	CTPA-FR (N)(V)(NV) G82~84	LRIS-4*5 (B)	LLR-25S (B)	
	5454681		12GX-SUB	●			12	12		12	0						
	5570676		12KX-SUB	●			120										
5		5505904	CTPAL10GX-SUB		●	16.0 ※	10	10	85	10	2	5.5	CTPA-FL (N)(K)(NV)(KV) G82~84	LRIS-4*5 (B)	LLR-25S (B)		
		5454699	12GX-SUB		●											20	
		5570684	12KX-SUB		●		12	12		12						0	
		5604871	16GX-SUB		●		16	16		85	16					28	
		5981659	16KX-SUB		●		120										

※ Would be changed by insert.

CTPA Series - Inserts (Ground Chipbreaker)

Shape	Item Number	※1 Max. Cut-off Dia (mm) ϕD	Dimensions (mm)				PVD Coated Carbide					PCD			
			w	A	※2 θ	r_ϵ	ZM3 Stock	QM3 Stock	VM1 Stock	DT4 Stock	PD1 Stock				
	CTPA07FR	8.0	0.7	0.23	16°	0.05	5501242	●							
	10FR	12.0	1.0	0.32			5501218	●							
	15FR	16.0	1.5	0.46			5248075	●	5270020 ●	5439328 ●	5855077 ●				
	20FR	16.0	2.0	0.61			5194113	●	5229596 ●	5439310 ●	5854997 ●				
	CTPA07FRN	8.0	0.7	—	0°	0.05	5512496	●							
	10FRN	12.0	1.0	—			5496880	●							
	15FRN	16.0	1.5	—			5271473	●	5556881 ●	5415096 ●	5855051 ●				
	20FRN	16.0	—	—			5199146	●	5562715 ●	5476338 ●	5854989 ●				
	20FRN-P	16.0	2.0	—									5781620 (1 corner) ●		
	30FRN	3.0	—	—					5789151 ●						
	CTPA07FL	8.0	0.7	0.23	16°	0.05	5501234	●							
	10FL	12.0	1.0	0.32			5501226	●							
	15FL	16.0	1.5	0.46			5342688	●			5855101 ●				
	20FL	16.0	2.0	0.61			5199138	●			5855036 ●				
	CTPA10FLN	12.0	—	—	0°	0.05	5496898	●							
	10FLND	12.0	1.0	—			5789599	●							
	15FLN	16.0	1.5	—			5286349	●	5562707 ●	5365747 ●	5855085 ●				
	20FLN	16.0	2.0	—			5199120	●	5250964 ●	5439351 ●	5854971 ●				
	20FLN-P	16.0	—	—									5781646 (1 corner) ●		
	30FLN	3.0	—	—					5782677 ●						
	CTPA07FLK	6.5	0.7	0.23	16°	0.05	5505912	●							
	10FLK	11.0	—	0.32			5496906	●							
	10FLKD	16.0	1.0	0.32			5789607	●							
	15FLK	14.5	1.5	0.46			5248083	●	5562699 ●	5476320 ●	5855093 ●				
	20FLK	14.5	2.0	0.61			5199112	●	5250774 ●	5439369 ●	5855002 ●				

※ 1: Max. cut-off diameter shows when X end point is 0.0. For more information, see page G67.
 ※ 2: All angles shown are obtained when insert is set in the holder.

CTPA Series - Inserts (Without Chipbreaker)

Shape	Item Number	※1 Max. Cut-off Dia (mm) ϕD	Dimensions (mm)				Carbide		PVD Coated Carbide					
			w	A	※2 θ	r_ϵ	KM1	Stock	ZM3	Stock	VM1	Stock		
	CTPA20FRS	16.0	2.0	-	0°	0.05			5378823	●				
Mirror finish 	CTPA20FRV			0.0	0.77	20°	5576038	●			5264916	●		
Mirror finish 	CTPA20FRNV					-	0°	5576046	●					
	CTPA20FLS					-	0°	0.05			5225255	●		
Mirror finish 	CTPA20FLV			2.0	0.77	20°						5264924	●	
Mirror finish 	CTPA20FLNV					-	0°	0.0	5576053	●				
Mirror finish 	CTPA20FLKV			14.5	0.77	20°			5576061	●			5264932	●

● Right-Hand style shown

※ 1 : Max. cut-off diameter shows when X end point is 0.0. For more information, see page G67.
 ※ 2 : All angles shown are obtained when insert is set in the holder.

SS Tools for Cutting off

CTPW Series Max. Cut-off Dia. ~ 20.0mm

CTPW

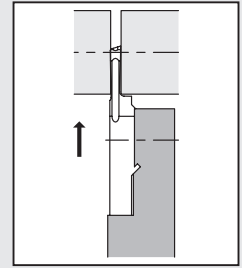
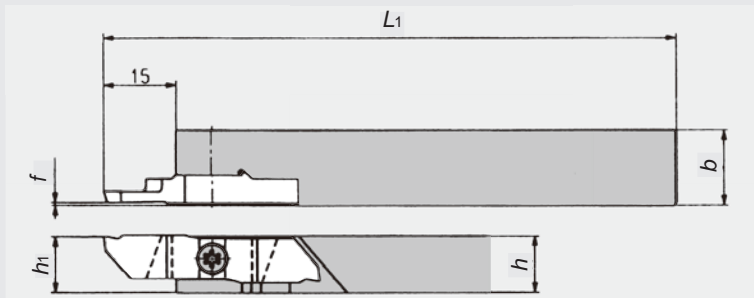

● Right-Hand style shown

CTPW Series - Toolholders

Code No.		Item Number	Stock		Max. Cut-off Dia (mm) ϕD	Dimensions (mm)					Gage insert	Spare Parts	
R	L		R	L		h	b	L ₁	h ₁	f		Clamp Screw	Wrench
—	5487004	CTPW^{R/L}10A	—	●	20.0	10	12	120	9.95	0.6			
5443593	—	10	●	—		16							
—	5488150	12A	—	●		12	12	11.95					
5443601	—	12	●	—		16							
5443627	5486980	16	●	●		16	16	15.95					
5443635	5486998	20	●	●		20	20	19.95					

CTPW Series - Inserts

Shape	Item Number	Chip-breaker	Max. Cut-off Dia (mm) ϕD	Dimensions (mm)					PVD Coated Carbide ZM3			
				w	A	θ	r _{e1}	r _{e2}	R	Stock	L	Stock
<p>● Left-Hand style shown</p>	 CTPW25F^{R/L}	—	20.0	2.5	0.81	17°	0.05	0.20	5437991	●	5487053	●
	 CTPW25F^{R/L}K	Yes			0.81	17°	0.05	0.20			5487012	●
	 CTPW25F^{R/L}N	—			—	0°	0.05	0.05	5438056	●	5487046	●
	 CTPW25F^{R/L}P	—			0.81	17°	0.05	0.20	5443650	●	5487038	●
	 CTPW25F^{R/L}NV	No			—	0°	0.00	0.00	5438049	●	5487020	●

※ 1 : Max. cut-off diameter shows when X end point is 0.0. For more information, see page G67.
 ※ 2 : All angles shown are obtained when insert is set in the holder.

CTV Series Max. Cut-off Dia. ~ 20.0mm

CTV-K2

Screw accessible from both sides

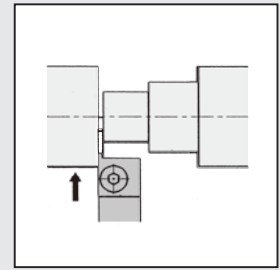
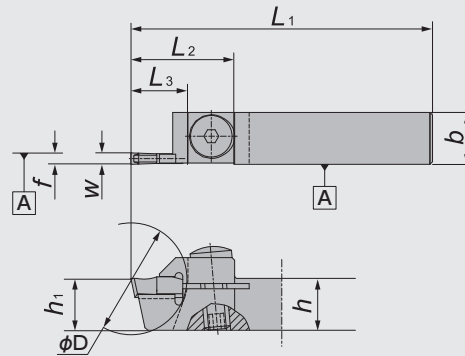

● Right-Hand style shown

Figure-1

CTVN-K2

Screw accessible from both sides

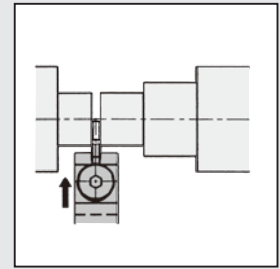
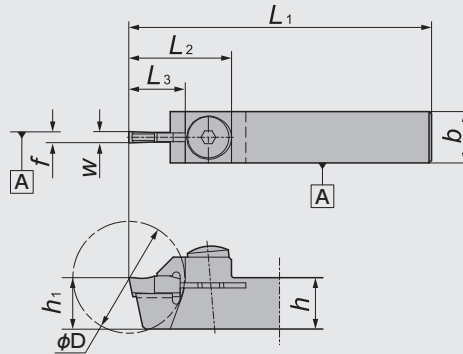

Figure-2

CTV Series - Toolholders

Figure	Code No.		Item Number	Stock		*1 Max. Cut-off Dia. (mm) ϕD	Dimensions (mm)						Gage insert	Spare Parts			
	R	L		R	L		w	h	b	L ₁	h ₁	f		L ₂	L ₃	Clamp Screw	Wrench
1	5111919	5111927	CTV ^{R/L} 10K2	●	●	20.0	2.2	10	10	120	10	0.0	20.0	11	CTV-S	AOS-5*16	LW-2.5S
		5459763	12GX2		●		2.2	12	12	85	12						
	5111950	5111935	12K2	●	●		2.2	12	12	120	12						
2	5208236		CTVN10K2	●		20.0	2.2	10	10	120	10	3.9	19.5	11	CTV-S	AOS-5*16	LW-2.5S
	5208244		12K2	●			2.2	12	12	120	12	4.9					

Note: f shows when takes CTV22.. insert.

*1: Max. cut-off diameter shows when X end point is 0.0. For more information, see page G67.

CTV Series - Inserts

Shape	Item Number	Dimensions (mm)					PVD Coated Carbide	
		w	L	A	*2 θ	r _ε	ZM3	Stock
<p>Single-sided</p> <p>CTV..N..S CTV..R..S CTV..L..S</p>	CTV22N05S	2.2	10	—	0°	0.05	5111976	●
	22N10S			—		0.10	5111992	●
	CTV25N05S	2.5		—		0.05	5112024	●
	25N10S			—		0.10	5112073	●
	CTV22R05S	2.2		0.74	17°	0.05	5111968	●
	22R10S			0.74		0.10	5112008	●
	CTV25R05S	2.5		0.83		0.05	5112032	●
	25R10S			0.83		0.10	5112065	●
	CTV22L05S	2.2		0.74		0.05	5111984	●
	22L10S			0.74		0.10	5112016	●
	CTV25L05S	2.5		0.83	0.05	5112040	●	
	25L10S			0.83	0.10	5112057	●	

*2: All angles shown are obtained when insert is set in the holder.

SS Tools for Cutting off

CTV Series Max. Cut-off Dia. ~ 45.0mm

CTV(-S)

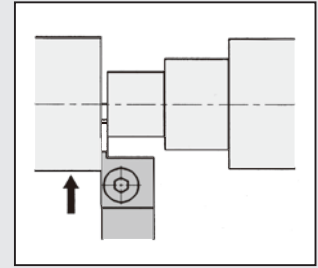
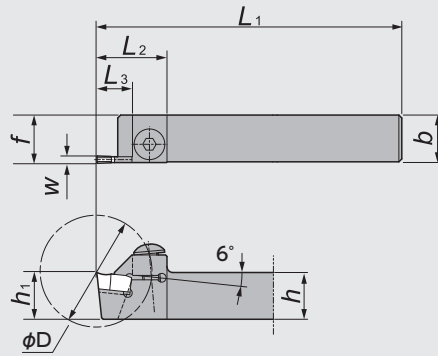

Figure-1

● Right-Hand style shown

CTV-X

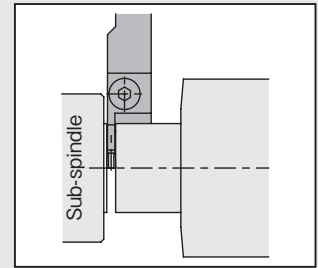
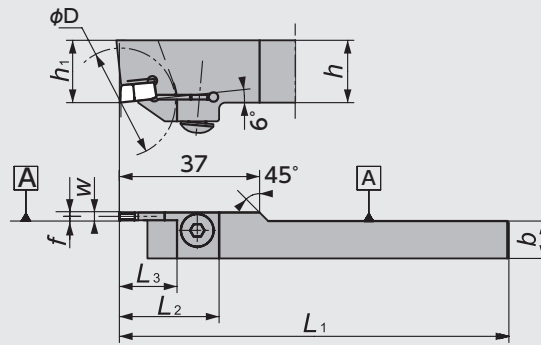

Figure-2

● Left-Hand style shown

CTV-M(B)

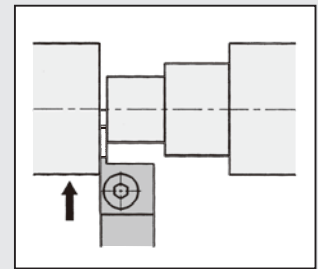
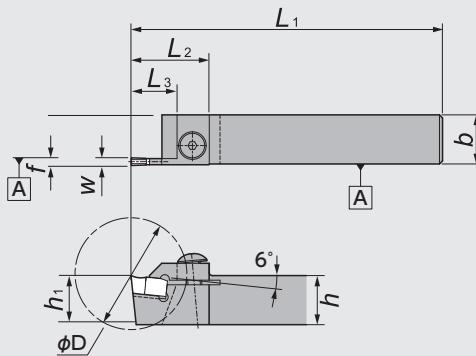







Figure-3

● Right-Hand style shown

CTV Series - Toolholders

Figure	Code No.		Item Number	Stock		*1 Max. Cut-off Dia (mm) ϕD	Dimensions (mm)							Gage insert	Spare Parts							
	R	L		R	L		w	h	b	L ₁	h ₁	f	L ₂		L ₃	Clamp Screw	Wrench					
1	5904131		CTV ^{R/L} 16K25S	●		23.0	2.5	16	16	125	16	16.5	24	12.2								
	5904180		20K25S	●				20	20		20	20.5										
	5904149		16K30S	●			3.0	16	16		16	16.5										
	5904172		20K30S	●				20	20		20	20.5										
	5853619	5853627	16K25	●	●	35.0	2.5	16	16		16	16.5	32	18.5				CTV25	BS0620	LW-4		
	5853643	5853635	20K25	●	●			20	20		20	20.5						CTV25				
	5853593	5853601	16K30	●	●		3.0	16	16		16	16.5						CTV30				
	5853577	5853585	20K30	●	●			20	20		20	20.5						CTV30				
		5120423	5122197	1913L25	●	●	3.0	2.5	19		13	140	19	13.0				CTV25				
		5120431	5122189	1913L30	●	●		3.0													CTV30	
2		5595384	CTVL2012K30X-1		●		3.0	20	12	125	20	3.0										
3	5177100		CTV ^{R/L} 16-25M	●		28.0	2.5	16	16	120	16	0.5	25.5	15								
	5185541		20-25M	●				20	20		20											
	5185566		16-30M	●			3.0	16	16		16							34.5			23.5	CTV30
	5183314		20-30M	●				20	20		20											
	5162219	5184528	25-30B	●	●		45.0	25	25		150							25				

*1 : Max. cut-off diameter shows when X end point is 0.0. For more information, see page G67.

CTV Series - Inserts

Shape	Item Number	Dimensions (mm)					PVD Coated Carbide			
		w	L	A	θ	r_ϵ	ZM3	Stock	QM3	Stock
<p>Single-sided</p>	CTV25N	2.5	12	—	0°	0.20	5862248	●		
	30N	3.0		—			5864145	●	5972997	●
	25R	2.5	0.41	8°		5868633	●			
	30R	3.0	0.49		5866892	●				
	25L	2.5	0.41							
	30L	3.0	0.49		5129564	●				
<p>Single-sided</p>	CTV30N038	3.0	12	—	0°	0.20	5524921	●		
<p>Single-sided</p>	CTV25R00A	2.5	12	0.41	8°	0.05 max.	5162003	●		
	30R00A	3.0		0.49			5185327	●		
	25R00B	2.5	0.83	17°	5185178	●				
	30R00B	3.0	1.00		5183223	●				

※ 2 : All angles shown are obtained when insert is set in the holder.

- New Products
- Tool Materials / Selection Guide
- Micrograin Carbide, BIDEIMCS, PCD, PVD Coated Carbide, CBN and Ceramics
- Insert Item List
- General Turning Toolholders
- Unique Swiss Tooling
- Grooving / Side Turning
- Threading
- Shaper
- ID Tooling
- Application Introduction
- Endmills
- Rotating Tools
- Information
- Index